

**Meeting of the Central Valley Flood Protection Board
January 25, 2019**

Staff Report

**Marysville Railroad Bridge Rehabilitation Project
Request to Initiate Project Review Pursuant to Title 33, USC Section 408**

1.0 – ITEM

Consider approval of a letter (Attachment A) to the U.S. Army Corps of Engineers (USACE), pursuant to federal Title 33, USC Section 408, requesting initiation of, in cooperation with the California Department of Transportation (Caltrans) and other federal agencies, a joint review of a possible modification to the State-Federal flood control project.

2.0 – PROJECT PROPONENT

California Department of Transportation (Caltrans)

3.0 – PROJECT LOCATION

The Marysville Railroad Bridge Rehabilitation Project includes the east and west levees along State Route 70 (SR 70) from the railroad bridge crossing at Binney Junction near Marysville, to approximately 1000 feet north along SR 70 in Yuba County.

4.0 – PROJECT DESCRIPTION

The purpose of this project is to expand SR 70 through the City of Marysville from two lanes to five lanes. Caltrans is proposing to setback the east levee from Binney Junction where the railroad bridge crosses SR 70 to approximately 1000 feet north along SR 70. Caltrans is also proposing to modify the west levee due to the replacement of the railroad bridge abutments. Proposed work may include construction of new levees and bridges, partial and full degrade of existing levees and bridges, landside fill, installation of cutoff walls, installation of relief wells, and modifications to impacted infrastructure (e.g. pumping plants, roads, and utilities).

The Board, on behalf of the State of California, does not anticipate seeking credit for the proposed work under Section 221 of the Flood Control Act of 1970 because the proposed project is currently not part of an ongoing or authorized Federal study.

Approval under Section 404 of the Clean Water Act is anticipated to be required for the proposed work. The proposed project will require lands owned by the non-Federal sponsor and will not require any lands owned by the USACE.

5.0 – STAFF RECOMMENDATIONS

Staff recommends the Board:

- **Approve:** The draft letter to the USACE in substantially the form provided; and
- **Delegate:** The Executive Officer to sign and send the letter to the USACE

6.0 – LIST OF ATTACHMENTS

- A. Draft Letter to the USACE
- B. Caltrans Letter of Intent request
- C. Project Map

Document Preparation: Greg Harvey, PE, Acting Branch Chief
Plan Implementation and Compliance Branch

Document Review: Michael Wright, PE, Acting Chief Engineer
Jit Dua, Board Counsel

CENTRAL VALLEY FLOOD PROTECTION BOARD

3310 El Camino Ave., Ste. 170
SACRAMENTO, CA 95821
(916) 574-0609 FAX: (916) 574-0682



January 25, 2019

Colonel David G. Ray, P.E.
District Commander
U.S. Army Corps of Engineers, Sacramento District
1325 J Street
Sacramento, California 95814

Subject: Request to initiate project review pursuant to Title 33, USC Section 408 for the California Department of Transportation (Caltrans) Marysville Railroad Bridge Rehabilitation Project.

Dear Colonel Ray:

Pursuant to Title 33, USC Section 408 (Section 408) as described by the U. S. Army Corps of Engineers (USACE) Engineering Circular 1165-2-220, Section 408, Paragraph 11 a. (Basic Requirements for a Complete Section 408 Request) the Central Valley Flood Protection Board (Board) offers a "Statement of No Objection" to initiate the Section 408 process for the joint review of possible alterations to the Marysville Levee District's "finger levee" in Yuba County.

As the non-federal sponsor for the project, the Board is aware of the scope of the Section 408 request and supports the request being submitted for review. The proposed Marysville Railroad Bridge Rehabilitation Project is located from Binney Junction in Marysville where the railroad tracks cross State Route (SR) 70, to approximately 1000 feet north along SR 70 in Yuba County. The purpose of this project is to widen SR 70 through the City of Marysville from two lanes to five lanes. To accomplish this, the east levee will need to be set back and modifications to the west levee will need to be made due to the replacement of the railroad bridge abutments near Binney Junction.

Proposed work may include construction of new levees, partial and full degrade of existing levees and roads, landside fill, installation of cutoff walls, installation of relief wells, and modifications to impacted infrastructure (e.g. pumping plants, roads, and utilities). Seepage design concerns along SR 70 within the Marysville Levee District's "finger levee" Phase 4B should be consistent with the USACE's authorized Marysville Ring Levee Project.

The proposed project is currently not part of an ongoing or authorized Federal study and is not eligible for credit under Section 221 of the Flood Control Act of 1970. Therefore, the Board is not seeking Section 221 credit. Approval under Section 404 of the Clean Water Act is anticipated to be required for these proposed alterations. The proposed project will require lands owned by the non-federal sponsor and will not require any lands owned by the USACE.

On behalf of Caltrans, the Board requests the USACE, in cooperation with other federal agencies, and Caltrans, to initiate a joint review of possible alterations for the proposed project. The Board, on behalf of Caltrans, will seek approval from the USACE to make necessary alterations to the levee system to achieve the project purpose.

Colonel David G. Ray
January 25, 2019
Page 2 of 2

Thank you for your attention to this request. We look forward to working with you and your staff on this project. If you have any questions regarding this request, please contact Mr. Greg Harvey of my staff at (916) 574-0454 or by email at greg.harvey@cvflood.ca.gov.

Sincerely,

Leslie M. Gallagher
Executive Officer

Enclosure: 33 USC § 408 Request from Caltrans dated December 7, 2018

cc: (via electronic file)

Mr. Jon Ericson, Chief
Division of Flood Management
California Department of Water Resources

Mr. Cameron Knudson, PE
California Department of Transportation
District 3 North Region

**DEPARTMENT OF TRANSPORTATION
DISTRICT 3 PROGRAM PROJECT
MANAGEMENT**

703 B STREET
MARYSVILLE, CA 95901
PHONE (530) 218-1820
FAX (530) 741-4245
TTY 711
www.dot.ca.gov/dist3



*Making Conservation
a California Way of Life.*

December 7, 2018

Ms. Leslie Gallagher, Executive Officer
Central Valley Flood Protection Board
3310 El Camino Avenue, Suite 170
Sacramento, California 95821

Dear Ms. Gallagher,

The California Department of Transportation (Caltrans) proposes to expand State Route 70 (SR 70) through the City of Marysville in Yuba County as part of its Marysville Railroad Bridge Rehabilitation Project. As shown on the attached plans, the east side of the Marysville Levee District's "finger levee" will be set back to expand SR 70 into a five-lane highway. Additionally, there will be some modifications made to the west finger levee because we will be replacing the bridge abutments near Binney Junction, which is located north of Marysville.

We are requesting assistance from the Central Valley Flood Protection Board (Board) in obtaining permission from the U.S. Army Corps of Engineers (USACE) to alter the federal project levee pursuant to Title 33, USC Section 408 for the Marysville Railroad Bridge Rehabilitation Project as explained above. We are also requesting that the Board and the USACE staff begin their review of the draft plans and assist us to obtain the Section 408 permission for implementing the proposed Marysville Railroad Bridge Rehabilitation Project.

If you need additional information to engage the USACE in this process, please contact me at (530) 218-1820 (cameron.knudson@dot.ca.gov); or you may contact our consultant, Mr. Jay Punia of Wood Rodgers, Inc. at (916) 870-0770 (jpunia@WoodRodgers.com).

Sincerely,

A handwritten signature in blue ink, reading "Cameron H. Knudson", is positioned above the typed name.

Cameron Knudson, PE
Project Manager

Attachment: Marysville Railroad Bridge Rehabilitation Project Plans

Ms. Gallagher
December 7, 2018
Page 2

cc: Mr. Michael Wright, CVFPB
Mr. Greg Harvey, CVFPB
Ms. Andrea Buckley, CVFPB
Mr. Mark Rayback, Wood Rodgers Inc.
Mr. Dean Zurcher, Wood Rodgers, Inc.
Mr. Jay Punia, Wood Rodgers, Inc.

INDEX OF SHEETS

SHEET No.	DESCRIPTION
1	TITLE AND LOCATION MAP

THE STANDARD PLANS LIST APPLICABLE TO THIS CONTRACT IS INCLUDED IN THE NOTICE TO BIDDERS AND SPECIAL PROVISIONS BOOK.

STATE OF CALIFORNIA
DEPARTMENT OF TRANSPORTATION
PROJECT PLANS FOR CONSTRUCTION ON
STATE HIGHWAY
IN YUBA COUNTY
IN MARYSVILLE
FROM 14TH STREET TO
0.1 SOUTH OF MILES CEMETARY ROAD

TO BE SUPPLEMENTED BY STANDARD PLANS DATED 2015

LOCATION OF CONSTRUCTION
PM 14.9 TO 16.5

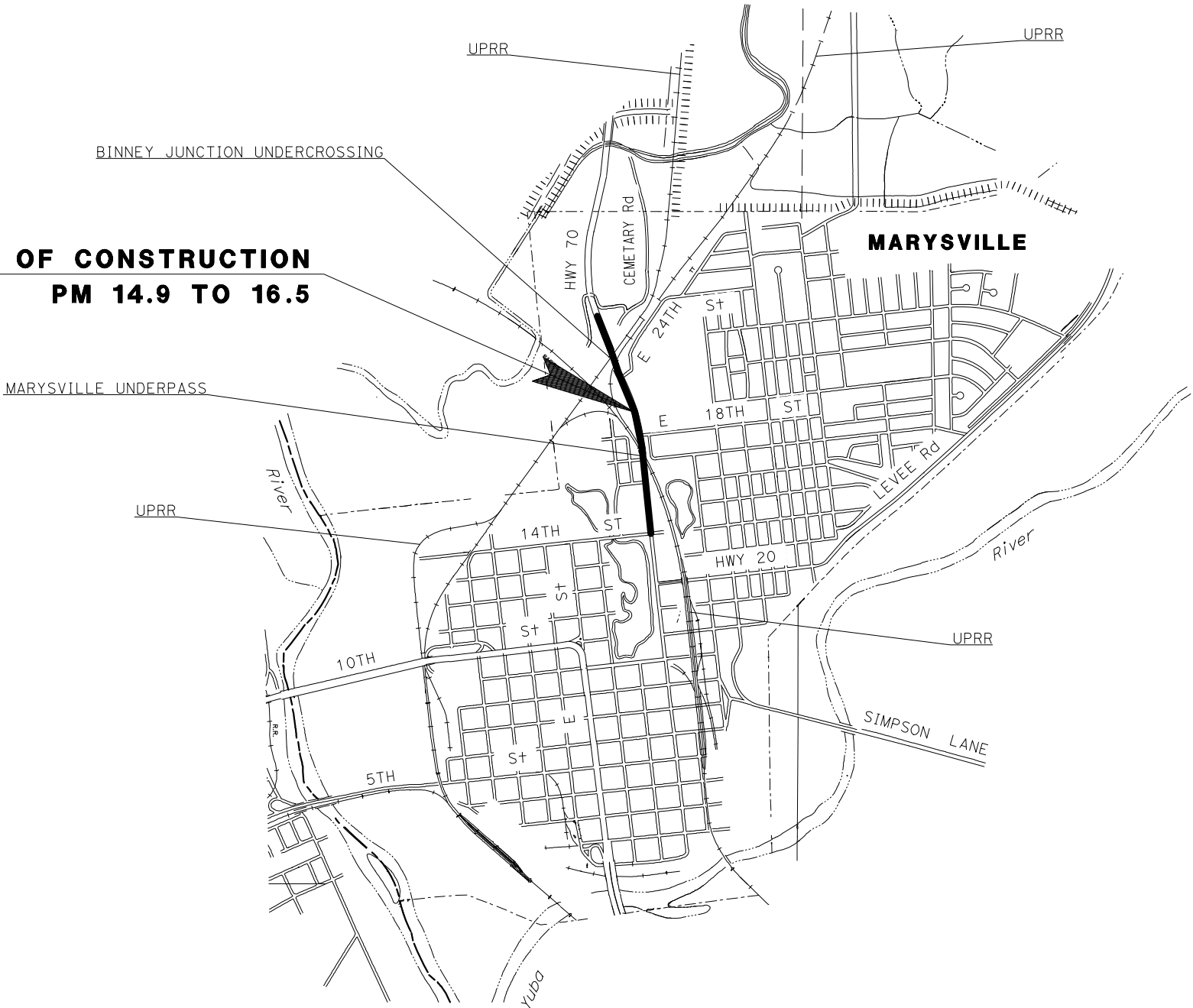

NO SCALE

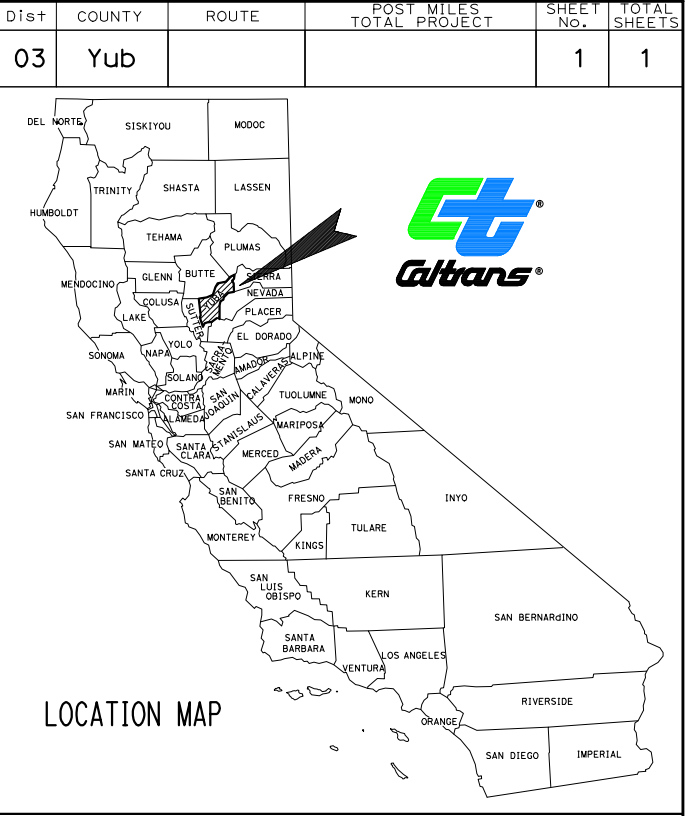

Attachment C

PROJECT MANAGER	SCOTT MANN
DESIGN ENGINEER	DEAN ZURCHER

THE CONTRACTOR SHALL POSSESS THE CLASS (OR CLASSES) OF LICENSE AS SPECIFIED IN THE "NOTICE TO BIDDERS."

PROJECT ENGINEER _____ DATE _____
REGISTERED CIVIL ENGINEER

PLANS APPROVAL DATE _____
THE STATE OF CALIFORNIA OR ITS OFFICERS OR AGENTS SHALL NOT BE RESPONSIBLE FOR THE ACCURACY OR COMPLETENESS OF SCANNED COPIES OF THIS PLAN SHEET.



CONTRACT No. **03-OH160**



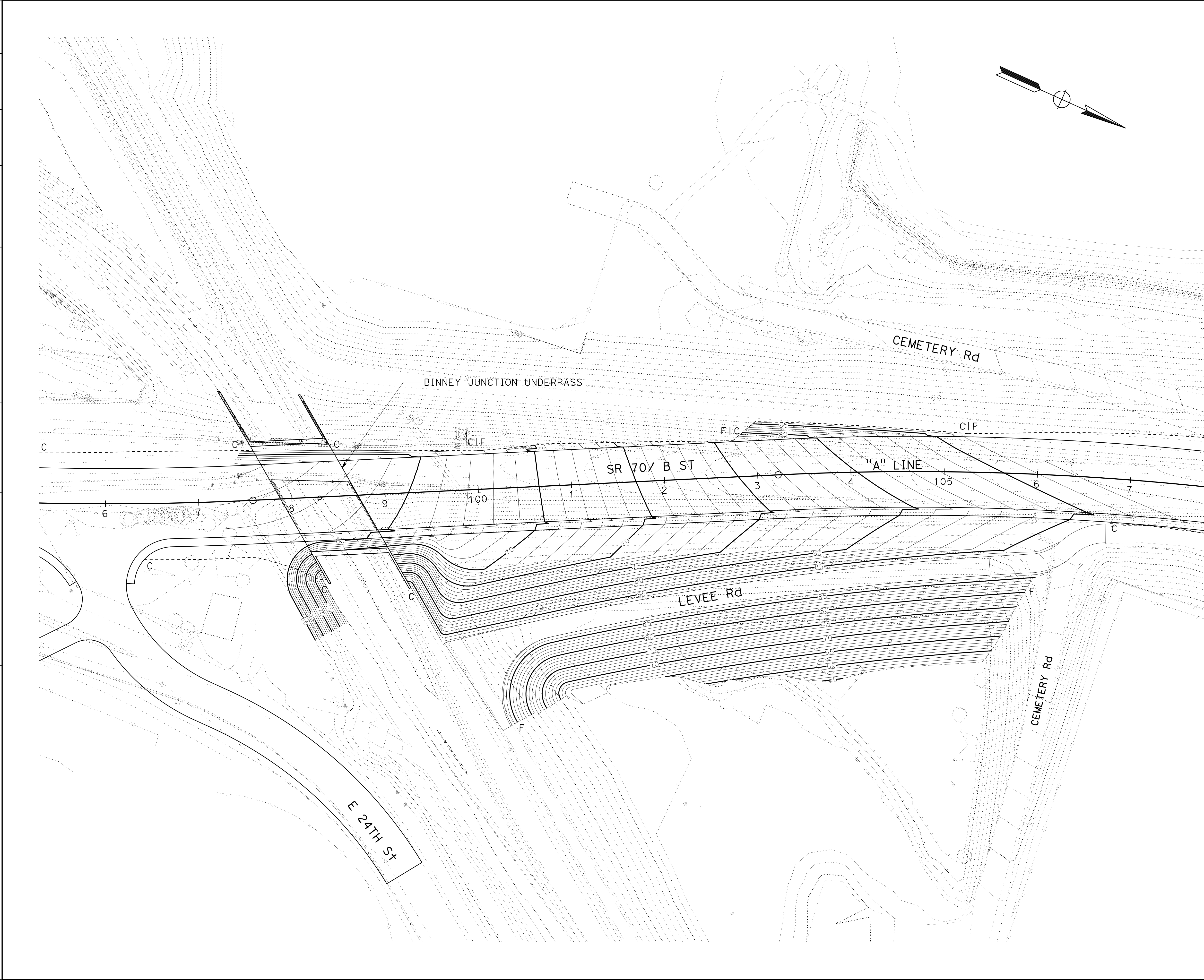

Dist	COUNTY	ROUTE	POST MILES TOTAL PROJECT	SHEET No.	TOTAL SHEETS
03	Yub	70	14.9/15.6		XXX

REGISTERED CIVIL ENGINEER

DATE

PLANS APPROVAL DATE

THE STATE OF CALIFORNIA OR ITS OFFICERS
OR AGENTS SHALL NOT BE RESPONSIBLE FOR
THE ACCURACY OR COMPLETENESS OF SCANNED
COPIES OF THIS PLAN SHEET.

Wood Rodgers Inc.
3301 C Street, Suite 100-B
Sacramento, CA 95816

DEAN A. ZURCHER

No. 86371

Exp. 3/31/19

CIVIL

STATE OF CALIFORNIA

Attachment C

CONTOUR GRADING

SCALE: 1" = 50'

G-1

