

**Meeting of the Central Valley Flood Protection Board  
May 25, 2012**

**Staff Report**

**Pacific Gas and Electric Company  
Overhead Wire Crossing, Yolo County**

---

**1.0 – ITEM**

Consider approval of Permit No. 18729 (Attachment B)

**2.0 – APPLICANT**

Pacific Gas and Electric Company

**3.0 – LOCATION**

The project is located where County Road 25 crosses the right (west) levee of the Yolo Bypass. (Yolo Bypass, Yolo County, see Attachment A)

**4.0 – DESCRIPTION**

Applicant proposes to install two wood power poles, securing a 12kv wire crossing county road 25 to serve irrigation well #8W-N2.

**5.0 – PROJECT ANALYSIS**

The project is to supply power to a new agricultural well in the Yolo Bypass. The project is necessary infrastructure for the operation of the well site and will have insignificant impacts to West Levee of the Yolo Bypass and the Yolo Bypass itself.

**5.3 – Hydraulic Analysis**

A Hydraulic Analysis is not needed for this project.

#### **5.4 – Geotechnical Analysis**

A Geotechnical Analysis is not needed for this project.

#### **6.0 – AGENCY COMMENTS AND ENDORSEMENTS**

The comments and endorsements associated with this project, from all pertinent agencies are shown below:

- Reclamation District 2035 has endorsed the project with no conditions.
- The U.S. Army Corps of Engineers 208.10 comment letter has not yet been received for this application. Staff anticipates receipt of a letter indicating that the USACE District Engineer has no objection to the project, subject to conditions. Upon receipt of the letter, staff will review to ensure conformity with the permit language and incorporate it into the permit as Exhibit A

#### **7.0 – CEQA ANALYSIS**

Board staff has prepared the following California Environmental Quality Act (CEQA) determination:

The Board has determined that the project is categorically exempt from CEQA under a Class 3 Categorical Exemption (CEQA Guidelines Section 15303) covering new construction of small structures.

#### **8.0 – SECTION 8610.5 CONSIDERATIONS**

1. Evidence that the Board admits into its record from any party, State or local public agency, or nongovernmental organization with expertise in flood or flood plain management:

The Board will make its decision based on the evidence in the permit application and attachments, this staff report, and any other evidence presented by any individual or group.

2. The best available science that related to the scientific issues presented by the executive officer, legal counsel, the Department or other parties that raise credible scientific issues.

The accepted industry standards for the work proposed under this permit as regulated by Title 23 have been applied to the review of this permit.

3. Effects of the decision on the entire State Plan of Flood Control:

This project will have no measureable effects on the entire state Plan of Flood Control.

4. Effects of reasonable projected future events, including, but not limited to, changes in hydrology, climate, and development within the applicable watershed:

Reasonable projected future events should have no effects on the proposed project.

### **9.0 – STAFF RECOMMENDATION**

Staff recommends that the Board find the project exempt from CEQA, approve the permit, and direct staff to file a Notice of Exemption with the State Clearinghouse.

### **10.0 – LIST OF ATTACHMENTS**

- A. Location Maps and photos
- B. Draft Permit No. 18729
- C. Drawings

Design Review:	Steve Dawson
Environmental Review:	Environmental Staff Assigned
Document Review:	Mitra Emami; Curt Taras; Len Marino



**ATTACHMENT "B" Aerial Map**

SECTION 05	TOWNSHIP 09N	RANGE 03E	MERIDIAN M.D.M.			
			PG&E			

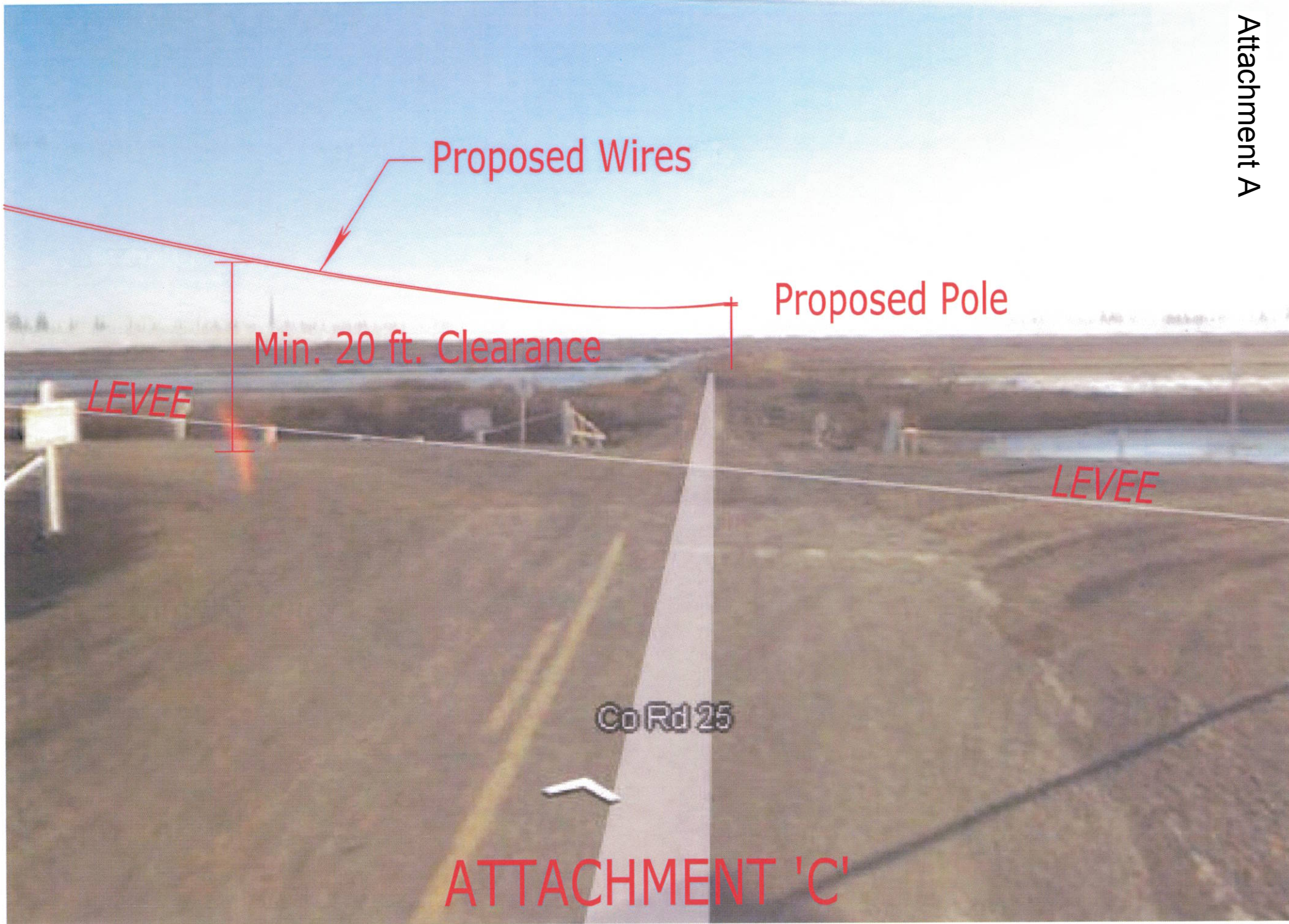

Proposed Wires

Proposed Pole

Min. 20 ft. Clearance

LEVEE

LEVEE

Co Rd 25

ATTACHMENT 'C'

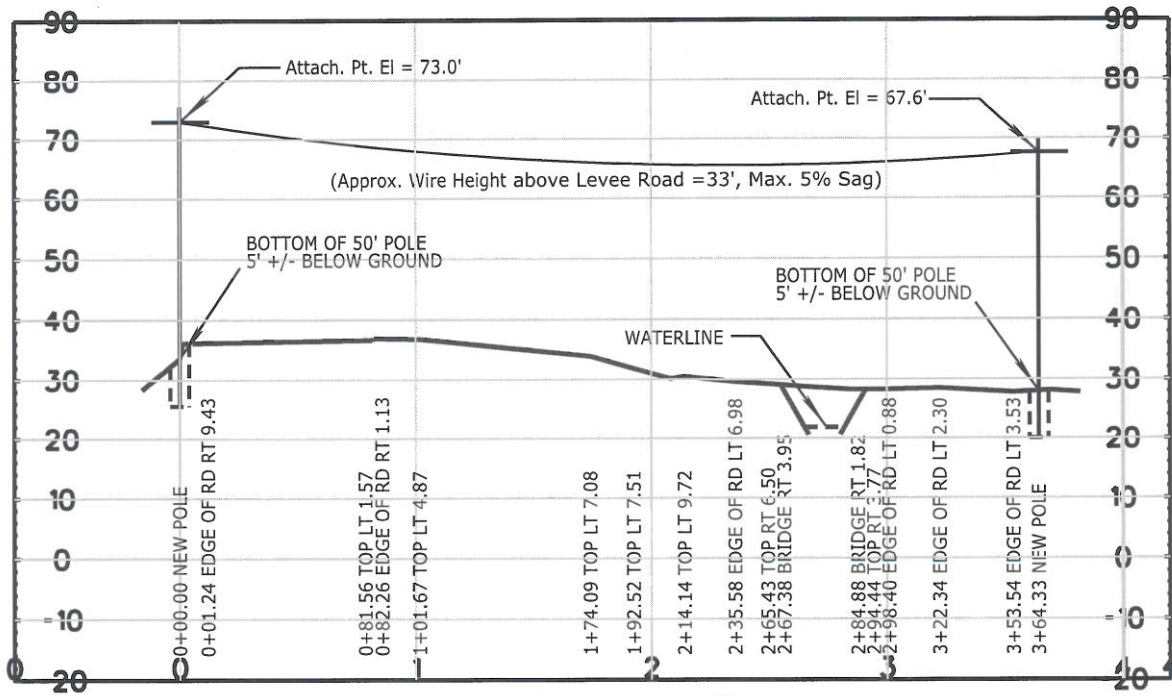

**CONAWAY PRESERVATION GROUP, LLC**

APN: 042-180-002  
REC. SER. NO. 2004-0057398

**CONAWAY PRESERVATION GROUP, LLC**

APN: 042-180-003  
REC. SER. NO. 2004-0057398

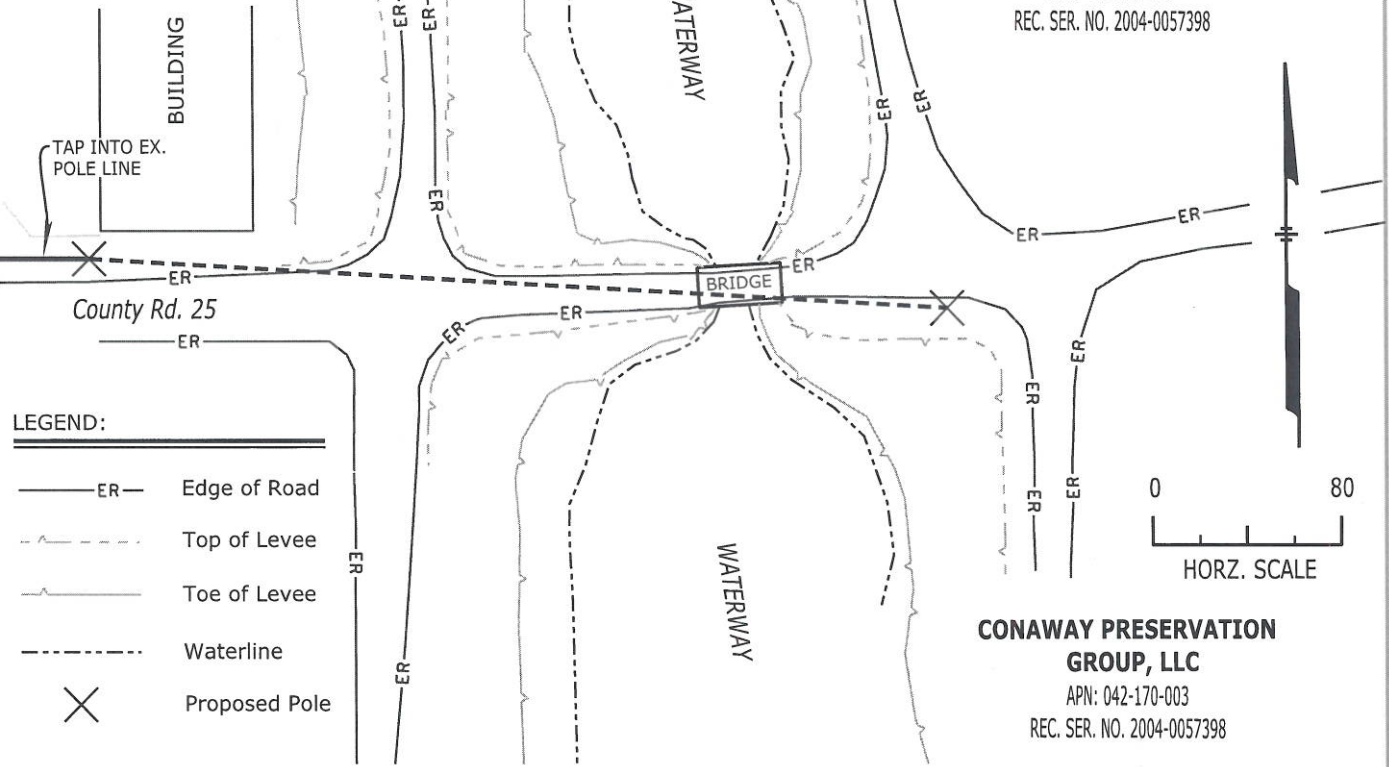

**CONAWAY PRESERVATION GROUP, LLC**

APN: 042-170-003  
REC. SER. NO. 2004-0057398

AUTHORIZATION  
30844392-0130

BY P. ATKINS  
DR P. ATKINS  
CH R. WONG  
O.K. J. O'NEAL  
DATE 11/16/11

**CONAWAY RANCH LEVEE  
WELL 8W-2N**

PACIFIC GAS AND ELECTRIC COMPANY  
San Francisco California



APPL.	CONAWAY RANCH	
AREA	6	
COUNTY	YOLO	
SCALE	1" = 80'	
SHEET NO.	2	OF 2
DRAWING NUMBER	L -9-3-8	
CHANGE	0	

**DRAFT**

STATE OF CALIFORNIA  
THE RESOURCES AGENCY  
**THE CENTRAL VALLEY FLOOD PROTECTION BOARD**

**PERMIT NO. 18729 BD**

**This Permit is issued to:**

Pacific Gas and Electric Company  
2730 Gateway Oaks Drive, Ste. 220  
Sacramento, California 95833

To install two wood power poles, securing a 12kv wire crossing county road to serve irrigation well #8W-N2. The project is located where County Road 25 crosses the right (west) levee of the Yolo Bypass. (Section 5, T9N, R3E, MDB&M, Reclamation District 2035, Yolo Bypass, Yolo County).

**NOTE:** Special Conditions have been incorporated herein which may place limitations on and/or require modification of your proposed project as described above.

**(SEAL)**

Dated: \_\_\_\_\_

\_\_\_\_\_

Executive Officer

**GENERAL CONDITIONS:**

**ONE:** This permit is issued under the provisions of Sections 8700 – 8723 of the Water Code.

**TWO:** Only work described in the subject application is authorized hereby.

**THREE:** This permit does not grant a right to use or construct works on land owned by the Sacramento and San Joaquin Drainage District or on any other land.

**FOUR:** The approved work shall be accomplished under the direction and supervision of the State Department of Water Resources, and the permittee shall conform to all requirements of the Department and The Central Valley Flood Protection Board.

**FIVE:** Unless the work herein contemplated shall have been commenced within one year after issuance of this permit, the Board reserves the right to change any conditions in this permit as may be consistent with current flood control standards and policies of The Central Valley Flood Protection Board.

**SIX:** This permit shall remain in effect until revoked. In the event any conditions in this permit are not complied with, it may be revoked on 15 days' notice.

**SEVEN:** It is understood and agreed to by the permittee that the start of any work under this permit shall constitute an acceptance of the conditions in this permit and an agreement to perform work in accordance therewith.

**EIGHT:** This permit does not establish any precedent with respect to any other application received by The Central Valley Flood Protection Board.

**NINE:** The permittee shall, when required by law, secure the written order or consent from all other public agencies having jurisdiction.

**TEN:** The permittee is responsible for all personal liability and property damage which may arise out of failure on the permittee's part to perform the obligations under this permit. If any claim of liability is made against the State of California, or any departments thereof, the United States of America, a local district or other maintaining agencies and the officers, agents or employees thereof, the permittee shall defend and shall hold each of them harmless from each claim.

**ELEVEN:** The permittee shall exercise reasonable care to operate and maintain any work authorized herein to preclude injury to or damage to any works necessary to any plan of flood control adopted by the Board or the Legislature, or interfere with the successful execution, functioning or operation of any plan of flood control adopted by the Board or the Legislature.

**TWELVE:** Should any of the work not conform to the conditions of this permit, the permittee, upon order of The Central Valley Flood Protection Board, shall in the manner prescribed by the Board be responsible for the cost and expense to remove, alter, relocate, or reconstruct all or any part of the work herein approved.

#### **SPECIAL CONDITIONS FOR PERMIT NO. 18729 BD**

**THIRTEEN:** All work approved by this permit shall be in accordance with the submitted drawings and specifications except as modified by special permit conditions herein. No further work, other than that approved by this permit, shall be done in the area without prior approval of the Central Valley Flood Protection Board.

**FOURTEEN:** The permittee shall maintain the permitted encroachment(s) and the project works within the utilized area in the manner required and as requested by the authorized representative of the Department of Water Resources, Reclamation District No. 2035 or any other agency responsible for maintenance.

**FIFTEEN:** Upon receipt of a signed copy of the issued (not approved only) permit the permittee shall contact the Department of Water Resources by telephone, (916) 574-0609, and submit the enclosed postcard to schedule a preconstruction conference. Failure to do so at least 10 working days prior to start of work may result in delay of the project.

**SIXTEEN:** The Central Valley Flood Protection Board, Department of Water Resources, and Reclamation District No. 2035 shall not be held liable for any damages to the permitted encroachment(s) resulting from flood fight, operation, maintenance, inspection, or emergency repair.

**SEVENTEEN:** The permittee may be required, at permittee's cost and expense, to remove, alter, relocate, or reconstruct all or any part of the permitted encroachment(s) if removal, alteration, relocation, or reconstruction is necessary as part of or in conjunction with any present or future flood control plan or project or if damaged by any cause. If the permittee does not comply, the Central Valley Flood Protection Board may remove the encroachment(s) at the permittee's expense.

**EIGHTEEN:** The permittee should contact the U.S. Army Corps of Engineers, Sacramento District, Regulatory Branch, 1325 J Street, Sacramento, California 95814, telephone (916) 557-5250, as compliance with Section 10 of the Rivers and Harbors Act and/or Section 404 of the Clean Water Act may be required.



NINETEEN: The permittee shall be responsible for repair of any damages to the project levee and other flood control facilities due to construction, operation, or maintenance of the proposed project.

TWENTY: The permittee is responsible for all liability associated with construction, operation, and maintenance of the permitted facilities and shall defend, indemnify, and hold the Central Valley Flood Protection Board and the State of California; including its agencies, departments, boards, commissions, and their respective officers, agents, employees, successors and assigns (collectively, the "State"), safe and harmless, of and from all claims and damages arising from the project undertaken pursuant to this permit, all to the extent allowed by law. The State expressly reserves the right to supplement or take over its defense, in its sole discretion.

TWENTY-ONE: The permittee shall defend, indemnify, and hold the Central Valley Flood Protection Board and the State of California, including its agencies, departments, boards, commissions, and their respective officers, agents, employees, successors and assigns (collectively, the "State"), safe and harmless, of and from all claims and damages related to the Central Valley Flood Protection Board's approval of this permit, including but not limited to claims filed pursuant to the California Environmental Quality Act. The State expressly reserves the right to supplement or take over its defense, in its sole discretion.

TWENTY-TWO: If the project, or any portion thereof, is to be abandoned in the future, the permittee or successor shall abandon the project under direction of the Central Valley Flood Protection Board and Department of Water Resources, at the permittee's or successor's cost and expense.

TWENTY-THREE: No construction work of any kind shall be done during the flood season from November 1 to April 15 without prior approval of the Central Valley Flood Protection Board.

TWENTY-FOUR: Cleared trees and brush shall be completely burned or removed from the floodway, and downed trees or brush shall not remain in the floodway during the flood season from November 1 to April 15.

TWENTY-FIVE: A minimum clearance of 21 feet shall be provided between the levee crown and the overhead wire crossing. Power cables over 750 volts shall have a minimum clearance of 25 feet.

TWENTY-SIX: The project site shall be restored to at least the condition that existed prior to commencement of work.

TWENTY-SEVEN: All debris generated by this project shall be disposed of outside the floodway and off the levee section.

TWENTY-EIGHT: All debris that may accumulate around the poles and guy wires within the floodway shall be completely removed from the floodway following each flood season.

TWENTY-NINE: Any additional encroachment(s) across the levee section or in the floodway, require an approved permit from the Central Valley Flood Protection Board and shall be in compliance with the Central Valley Flood Protection Board's regulations (Title 23 California Code of Regulations).

THIRTY: The permittee shall comply with all conditions set forth in the letter from the Department of

the Army dated May XX, 2012, which is attached to this permit as Exhibit A and is incorporated by reference.