

**Meeting of the Central Valley Flood Protection Board
December 16, 2011**

**Staff Report – Encroachment Permit
California Department of Transportation, District 10
State Route 99 Manteca Widening Project – South Fork of South Littlejohns
Creek, San Joaquin County, CA**

1.0 – ITEM

Consider approval of Permit No. 18664 (Attachment B).

2.0 – APPLICANT

California Department of Transportation, District -10

3.0 – LOCATION

The project is located at the South Fork of South Littlejohns Creek and SR99 in San Joaquin County California (Attachment-C).

4.0 – DESCRIPTION

The proposed project consists of widening the existing bridge crossing over the South Fork South Little Johns Creek by 35 ft, 4 in within the median to provide an additional 12 ft lane and 10 ft shoulder in each direction of travel, separated by a concrete barrier (Type 60A Modified). Approximately 14 CY of rock slope protection will be placed within the north abutment, approximately 20 ft beyond the existing bridge edges. The concrete slope protection will have a cut off wall depth of 4 ft.

Vegetation within the project footprint will be cleared to allow for equipment to access the area and complete construction. After construction, the disturbed soils will be re-vegetated with grasses.

5.0 – PROJECT ANALYSIS

The following project analyses have been made based on the review of the available technical information provided by the applicant and the applicants engineer HDR, Inc.

This Bridge is a widening project of the North Bound and South Bound existing bridge of Highway – 99. The plan is to close the gap between the two 37 foot- 8 inch outer bridges with the median widening and to continue the top of roadway deck at the 1.5

percent drainage slope. Under Title-23; Code of Regulations, Section 128(10)(B): “When an existing bridge being widened does not meet the clearance requirement above the design flood plane, the bottom structural members of the added section may be no lower than the bottom structural members of the existing bridge, except as may be caused by the extension of existing sloped structural members.” This is the case for this project. (See Attachment-F; Figure 3).

Cal Trans will restore all levee slopes and roadways to pre-project condition and follow all standards and guidelines as applicable, in Title 23 of the California Water Code for construction activities on levees and within the floodway. The relevant Title 23 sections are:

- 112. Streams Regulated and No permissible Work Periods
- 115. Dredged Spoil, and Waste Material
- 116. Borrow and Excavated Activities – Land and Channel
- 121. Erosion Control
- 128. Bridges
- 130. Patrol Roads and Access Ramps

5.1 – Background

The California Department of Transportation (CalTrans) and the Federal Highway Administration, in cooperation with the City of Manteca, San Joaquin County, and the San Joaquin Council of Governments propose to widen State Route 99 to six lanes within the median from Austin Road interchange in the City of Manteca (post Mile 4.9) to the Arch Road interchange in the City of Stockton (post mile 15.0). the total length of the proposed project also incorporates a number of structural and operational improvements to overcrossings and interchanges throughout the project area, specifically at Lathrop Road, Main Street and French Camp Road.

State Route 99 is the principle north/ south highway traversing the major cities within California’s Central Valley. This specific permit application deals with one of many crossings within the CVFPB jurisdiction, namely the South Fork of South Littlejohns Creek.

5.2 – Hydraulic Analysis

The design hydraulic study for this project was prepared by HDR Engineering Inc. in Folsom, California and dated July 1, 2011 and revised August 25, 2011. A HEC-RAS Model was used to determine the water surface profile. The designers estimated design flow for the 1 percent chance event (100 year storm) is: 2,600 cfs utilizing FEMA flow rates. However, the Department of Water Resources, Flood Channel Design Flows of 1985 dictate that the combined outflow of Lone Tree Creek and North & South Forks of south Littlejohns Creek is only 1,750 cfs. This is the design flow that the Board would accept. So the model run by CalTrans consultant engineer is very conservative.

The design flow has a small enough magnitude and a small debris load as stated by San Joaquin County Flood Control and Water Conservation District dated August 31, 2011 (per Attachment-H) that per Title-23, Code of Regulations, Section 128(10)(A) the freeboard clearance (distance from the Design Water Surface Elevation to the Bridge Soffit (The low chord elevation) maybe 2.0 feet.

In the HEC-RAS model, utilizing the high hundred year flow of 2,600 cfs, we find the bridge upstream proposed soffit elevation of 29.84 feet and the models water surface elevation of 28.72 feet for the existing and proposed conditions. This equates to a freeboard clearance of **1.12 feet**. At the downstream outlet of the proposed bridge, the soffit elevation is 30.10 feet with the models water surface elevation of 28.21 feet for existing and proposed conditions. This equates to a freeboard clearance of **1.89 feet**.

Given that this project design storm of 2,600 cfs has been designed with a storm 1.5 times higher than what is allowed (1,750 cfs), Board staff is in agreement with the lesser freeboard and the intent of the Title-23, Code of Regulations has been met.

Pier scour potential:

Given the design storm of 2,600 cfs, existing and proposed velocities are 6.3 fps which are on the erosive edge of the channel. In the Hydrology and Hydraulic Report, under findings & Conclusion (page 13 & 14 of the report) the total scour is;

<u>Location</u>	<u>Total Scour</u>
Left Abutment	3.85 ft.
Pier-1	5.18
Pier-2	5.18
Pier-3	5.18
Right Abutment	3.57

Cal Trans consultant, HDR Inc., recommends that Rock Rip-Rap Slope Protection be provided to eliminate scour potential at the bridge crossing. That rock treatment should occur 20 feet upstream of the bridge centerline to 20 feet downstream and that a concrete cut-off wall be applied adjacent to and along the full length of the existing cut-off wall in Bent -2 (see Attachment-F; General Plan, Sheet-1).

The HEC-RAS files for this reach show a “Manning’s Roughness Coefficient” of 0.04 which is smooth for Grouted Rock Rip-Rap. If this is the case then, the permit will reflect very little rock exposure in this formed concrete.

5.3– Geotechnical Summary

Blackburn Consulting prepared the Final Foundation Report on January 6, 2011 (their File No. 1201.7c). The consultant retained Precision Drilling to drill and sample two exploratory borings at the site to characterize the subsurface conditions and obtain samples for laboratory testing. The drillers used a CME 75 truck-mounted rig to drill the borings using 8-inch outside diameter hollow stem auger.

Laboratory Testing consisted of:

- Moisture Content and Unit Weight
- Grain Size Analysis
- Atterberg Limits
- Unconfined Compressive Strength
- Triaxial Shear Strength
- Corrosivity (ph, Resistivity, Sulfates and Chlorides)

Local Geology consists of underlain sediments of the Pleistocene-age Modesto Formation. These sediments are alluvium comprised mostly of sand and clay. The subsurface soils are:

<u>Depth</u>	<u>Type</u>
5.5' to 6.5'	Medium density silty sand fills
10.0'	Stiff lean clay fills
54.0'	interlayered very stiff lean clay to sandy lean clay with thin layers of medium dense poorly graded sand/ silts.
Deeper	hard sandy lean clay and very dense clayey sand

Water levels were encountered at 43.0 to 45.0 feet.

The site does not lie within or adjacent to an Earthquake Fault Zone for fault rupture hazard. The 1.5:1 and flatter canal slopes have a low to nonexistence design peak ground acceleration.

5.4 – Staff Comments

The project has little effect on the Flood Control System and is an improvement.

6.0 – AGENCY COMMENTS AND ENDORSEMENTS:

The comments and endorsements associated with this project, from all pertinent agencies are shown below:

- A U.S. Army Corps of Engineers comment letter is expected to be received prior to the December 2, 2011 Board meeting and shall be incorporated by reference to Permit No. 18663 as Exhibit A.
- The San Joaquin County Flood Control & Water Conservation District has endorsed this project with conditions which have been incorporated into the permit as (Attachment-B Exhibit-B).

6.1 – Owners of the property on which the project is located

Cal Trans District 10 in Stockton

Lagorio Properties LP APN 201-050-07
Joe Marchesotti CO INC. APN 201-020-05

7.0 – PROPOSED CEQA FINDINGS:

Board staff has prepared the following CEQA Findings:

The Board, as a responsible agency under CEQA, has reviewed Draft and Final Initial Study/Mitigated Negative Declaration (IS/MND, SCH Number: 2009112045, November 2009, March 2010) and the Mitigation Monitoring Plan for the State Route 99 Manteca Widening Project prepared by the lead agency, Caltrans. These documents, including project design, may be viewed or downloaded from the Central Valley Flood Protection Board website at <http://www.cvfpb.ca.gov/meetings/2011/12-02-2011.cfm> under a link for this agenda item. These documents are also available for review in hard copy at the Board and the Caltrans District 10 offices.

Caltrans has determined that the project would not have a significant effect on the environment and adopted the IS/MND on March 18, 2010 and subsequently filed a Notice of Determination on March 26, 2010 with the State Clearinghouse. Board staff finds that although the proposed project could have a potentially significant effect on the environment, there will not be a significant effect in this case because revisions in the project have been made by or agreed to by the project proponent. The project proponent has incorporated mandatory mitigation measures into the project plans to avoid identified impacts or to mitigate such impacts to a point where no significant impacts will occur. These mitigation measures are included in the project proponent's Mitigation Monitoring Plan and address impacts to biological resources, hazards and hazardous materials, and noise. The description of the mitigation measures are further described in the adopted Mitigation Monitoring Plan.

8.0 – SECTION 8610.5 CONSIDERATIONS

1. Evidence that the Board admits into its record from any party, State or local public agency, or nongovernmental organization with expertise in flood or flood plain management:

The Board will make its decision based on the evidence in the permit application and attachments, this staff report, and any other evidence presented by any individual or group.

2. The best available science that related to the scientific issues presented by the executive officer, legal counsel, the Department or other parties that raise credible scientific issues.

The accepted industry standards for the work proposed under this permit as regulated by Title 23 have been applied to the review of this permit.

3. Effects of the decision on the entire State Plan of Flood Control:

This project has no negative impacts on the State Plan of Flood Control. Both hydraulic and structural impacts from the project construction are negligible.

4. Effects of reasonable projected future events, including, but not limited to, changes in hydrology, climate, and development within the applicable watershed:

Climate change issues have not been taken into account in the hydraulic analysis for this project; however, it is assumed to be inland past the point tidal influence raises in WSE, and due to the excessive amount of freeboard in the channel at this location, the project would have an ample factor of safety built into it. Climate change WSE raises are only estimated from 6-inches to 1-foot of impact and would be well within the freeboard of this project in the event that tidal influences did reach further inland than expected. There are no other foreseeable projected future events that would impact this project.

9.0 – STAFF RECOMMENDATION

Staff recommends that the Board adopt the CEQA findings, approve the permit conditioned upon receipt and review of a favorable U.S. Army Corps of Engineers 208.10 comment letter and direct staff to file a Notice of Determination with the State Clearinghouse.

10.0 – LIST OF ATTACHMENTS

- A. Resolution No. (None required under consent items)
- B. Draft Permit No. 18664
 - Exhibit A – U.S. Army Corps of Engineers 208.10 Comment Letter
 - Exhibit B – San Joaquin County Flood Control & Water Conservation District, letter dated December 27, 2010.
- C. Location Map
- D. Vicinity Map
- E. Bridge Project cover sheet.
- F. Construction Drawings. Figs. 3&4
- G. HEC-RAS Water Surface Plan & Cross Section for Bridge
- H. S.J.Co. Flood Control & Water Conservation District letter dated Aug. 31, 2011 from John Maguire, Engineering Services Manager.
- I. Photo

Report Completed by:	David R. Williams, P.E.
Design Review:	David R. Williams, P.E.
Environmental Review:	James Herota, E.S. and Andrea Mauro, E.S.
Document Review:	Eric Butler, P.E. – Supervising Engineer Len Marino, P.E. – Chief Engineer

STATE OF CALIFORNIA
THE RESOURCES AGENCY
THE CENTRAL VALLEY FLOOD PROTECTION BOARD

PERMIT NO. 18664 BD

This Permit is issued to:

California Department of Transportation
2015 East Shields Avenue, Suite A-100
Fresno, California 93728-5428

To widen the existing bridge crossing over the South Fork South Little Johns Creek by 35 ft, 4 in within the median to provide an additional 12 ft lane and 10 ft shoulder in each direction of travel, separated by a concrete barrier (Type 60A Modified). Approximately 14 CY of rock slope protection will be placed within the north abutment, approximately 20 ft beyond the existing bridge edges. The concrete slope protection will have a cut off wall depth of 4 ft.

South Fork South Littlejohns Creek and SR99 (Section 29, T1S, R7E, W, San Joaquin County Flood Control and Water Conservation District, Littlejohns Creek, San Joaquin County).

NOTE: Special Conditions have been incorporated herein which may place limitations on and/or require modification of your proposed project as described above.

(SEAL)

Dated: _____

Executive Officer

GENERAL CONDITIONS:

ONE: This permit is issued under the provisions of Sections 8700 – 8723 of the Water Code.

TWO: Only work described in the subject application is authorized hereby.

THREE: This permit does not grant a right to use or construct works on land owned by the Sacramento and San Joaquin Drainage District or on any other land.

FOUR: The approved work shall be accomplished under the direction and supervision of the State Department of Water Resources, and the permittee shall conform to all requirements of the Department and The Central Valley Flood Protection Board.

FIVE: Unless the work herein contemplated shall have been commenced within one year after issuance of this permit, the Board reserves the right to change any conditions in this permit as may be consistent with current flood control standards and policies of The Central Valley Flood Protection Board.

SIX: This permit shall remain in effect until revoked. In the event any conditions in this permit are not complied with, it may be revoked on 15 days' notice.

SEVEN: It is understood and agreed to by the permittee that the start of any work under this permit shall constitute an acceptance of the conditions in this permit and an agreement to perform work in accordance therewith.

EIGHT: This permit does not establish any precedent with respect to any other application received by The Central Valley Flood Protection Board.

NINE: The permittee shall, when required by law, secure the written order or consent from all other public agencies having jurisdiction.

TEN: The permittee is responsible for all personal liability and property damage which may arise out of failure on the permittee's part to perform the obligations under this permit. If any claim of liability is made against the State of California, or any departments thereof, the United States of America, a local district or other maintaining agencies and the officers, agents or employees thereof, the permittee shall defend and shall hold each of them harmless from each claim.

ELEVEN: The permittee shall exercise reasonable care to operate and maintain any work authorized herein to preclude injury to or damage to any works necessary to any plan of flood control adopted by the Board or the Legislature, or interfere with the successful execution, functioning or operation of any plan of flood control adopted by the Board or the Legislature.

TWELVE: Should any of the work not conform to the conditions of this permit, the permittee, upon order of The Central Valley Flood Protection Board, shall in the manner prescribed by the Board be responsible for the cost and expense to remove, alter, relocate, or reconstruct all or any part of the work herein approved.

SPECIAL CONDITIONS FOR PERMIT NO. 18664 BD

THIRTEEN: If the construction project extends onto land owned in fee and/or easement by the Sacramento and San Joaquin Drainage District acting by and through the Central Valley Flood Protection Board (Board), the permittee should secure an easement, license, or temporary entry permit from the Board prior to commencement of work. Contact Angelica Aguilar at (916) 653-5782.

FOURTEEN: All work approved by this permit shall be in accordance with the submitted drawings and specifications except as modified by special permit conditions herein. No further work, other than that approved by this permit, shall be done in the area without prior approval of the Central Valley Flood Protection Board.

FIFTEEN: Prior to demolition and/or construction activities any and all easements, both temporary and permanent, shall be obtained by the applicant.

SIXTEEN: There shall be no plantings within the project area under this permit, except that of native grasses, which may be required for slope protection.

SEVENTEEN: The permittee shall defend, indemnify, and hold the Central Valley Flood Protection Board and the State of California, including its agencies, departments, boards, commissions, and their respective officers, agents, employees, successors and assigns (collectively, the "State"), safe and harmless, of and from all claims and damages related to the Central Valley Flood Protection Board's approval of this permit, including but not limited to claims related to the California Environmental Quality Act. The State expressly reserves the right to supplement or take over its defense, in its sole discretion.

EIGHTEEN: The mitigation measures approved by the CEQA lead agency and the permittee are found in the Final Initial Study/Mitigated Negative Declaration adopted by the CEQA lead agency. The permittee shall implement all such mitigation measures.

NINETEEN: The permittee is responsible for all liability associated with construction, operation, and maintenance of the permitted facilities and shall defend and hold the Central Valley Flood Protection Board and the State of California; including its agencies, departments, boards, commissions, and their respective officers, agents, employees, successors and assigns (collectively, the "State"), safe and harmless, of and from all claims and damages arising from the project undertaken pursuant to this permit, all to the extent allowed by law. The State expressly reserves the right to supplement or take over its defense, in its sole discretion.

TWENTY: The Central Valley Flood Protection Board, Department of Water Resources, and the San Joaquin County Flood Control and Water Conservation District shall not be held liable for damages to the permitted encroachment(s) resulting from releases of water from reservoirs, flood fight, operation, maintenance, inspection, or emergency repair.

TWENTY-ONE: No construction work of any kind shall be done during the flood season from November 1 to April 15 without prior approval of the Central Valley Flood Protection Board.

TWENTY-TWO: Prior to start of any demolition and/or construction activities within the floodway, the applicant shall provide the Central Valley Flood Protection Board with two sets of layout plans for any and all temporary, inchannel cofferdam(s), gravel workpad(s), work trestle(s), scaffolding, piles and/or other appurtenances that are to remain in the floodway during the flood season from November 1 through April 15.

TWENTY-THREE: A civil engineer registered in the State of California representing the permittee shall provide periodic reports and records to the Department of Water Resources that are acceptable to the Central Valley Flood Protection Board which certifies that all work accomplished by contract to the permittee was thoroughly inspected and performed in accordance with submitted drawings, specifications, and permit conditions.

TWENTY-FOUR: Debris that may accumulate on the permitted encroachment(s) and/or any temporary falsework within the floodway shall be cleared off and disposed of outside the floodway after each period of high water.

TWENTY-FIVE: The permittee shall contact the Department of Water Resources by telephone, (916) 574-0609, and submit the enclosed postcard to schedule a preconstruction conference. Failure to do so at least 10 working days prior to start of work may result in delay of the project.

TWENTY-SIX: The permittee shall provide supervision and inspection services acceptable to the Central Valley Flood Protection Board.

TWENTY-SEVEN: Temporary staging, formwork, stockpiled material, equipment, and temporary buildings shall not remain in the floodway during the flood season from November 1 to April 15.

TWENTY-EIGHT: Cleared trees and brush shall be completely burned or removed from the floodway, and downed trees or brush shall not remain in the floodway during the flood season from November 1

to April 15.

TWENTY-NINE: Fill material shall be placed only within the area indicated on the approved plans.

THIRTY: Backfill material for excavations shall be placed in 4- to 6-inch layers and compacted to at least the density of the adjacent, firm, undisturbed material.

THIRTY-ONE: Density tests by a certified materials laboratory will be required to verify compaction of backfill within the floodway.

THIRTY-TWO: The soffit of the bridges shall be no lower than that of the existing adjacent bridges which is 29.24 feet, NGVD 29.

THIRTY-THREE: Revetment shall be uniformly placed and properly transitioned into the bank, levee slope, or adjacent revetment and in a manner which avoids segregation.

THIRTY-FOUR: Concrete Rock Rip-Rap Revetment shall be quarry stone or cobbles and only 10 percent shall be exposed above the concrete slurry surface. The rock shall at least meet the following grading:

Quarry Stone		Cobbles	
Stone Size	Percent Passing	Stone Size	Percent Passing
15 inches;	100	15 inches;	100
8 inches;	80-95	10 inches;	55-95
6 inches;	45-80	8 inches;	35-65
4 inches;	15-45	6 inches;	10-35
2 inches;	0-15	3 inches;	1-5

THIRTY-FIVE: The revetment shall not contain any reinforcing steel, floatable, or objectionable material. Asphalt or other petroleum-based products may not be used as fill or erosion protection on the levee section or within the floodway.

THIRTY-SIX: Follow Title 23; California Code of Regulations, Section 121 for Rock Rip-Rap requirements.

THIRTY-SEVEN: All debris generated by this project shall be disposed of outside the floodway.

THIRTY-EIGHT: The levee section shall be restored to at least the same condition that existed prior to commencement of work.

THIRTY-NINE: The work area shall be restored to the condition that existed prior to start of work.

FORTY: The permittee shall submit as-built drawings to the Department of Water Resources' Flood Project Inspection Section upon completion of the project.

FORTY-ONE: If the project result(s) in an adverse hydraulic impact, the permittee shall provide appropriate mitigation measures, to be approved by the Central Valley Flood Protection Board, prior to implementation of mitigation measures.

FORTY-TWO: In the event that levee or bank erosion injurious to the adopted plan of flood control occurs at or adjacent to the permitted encroachment(s), the permittee shall repair the eroded area and propose measures, to be approved by the Central Valley Flood Protection Board, to prevent further erosion.

FORTY-THREE: The permittee shall maintain the permitted encroachment(s) and the project works within the utilized area in the manner required and as requested by the authorized representative of the Department of Water Resources or any other agency responsible for maintenance.

FORTY-FOUR: The permitted encroachment(s) shall not interfere with operation and maintenance of the flood control project. If the permitted encroachment(s) are determined by any agency responsible for operation or maintenance of the flood control project to interfere, the permittee shall be required, at permittee's cost and expense, to modify or remove the permitted encroachment(s) under direction of the Central Valley Flood Protection Board or Department of Water Resources. If the permittee does not comply, the Central Valley Flood Protection Board may modify or remove the encroachment(s) at the permittee's expense.

FORTY-FIVE: The permittee may be required, at permittee's cost and expense, to remove, alter, relocate, or reconstruct all or any part of the permitted encroachment(s) if removal, alteration, relocation, or reconstruction is necessary as part of or in conjunction with any present or future flood control plan or project or if damaged by any cause. If the permittee does not comply, the Central Valley Flood Protection Board may remove the encroachment(s) at the permittee's expense.

FORTY-SIX: If the project, or any portion thereof, is to be abandoned in the future, the permittee or successor shall abandon the project under direction of the Central Valley Flood Protection Board and Department of Water Resources, at the permittee's or successor's cost and expense.

FORTY-SEVEN: The permittee shall comply with all conditions set forth in the letter from the U.S. Army Corps of Engineers dated xxxxxxxx, 2011, which is attached to this permit as Exhibit A and incorporated by reference.

FORTY-EIGHT: The permittee shall comply with all conditions set forth in the San Joaquin County Flood Control and Water Conservation District letter dated December 27, 2010 and letter, and letter dated August 31, 2011 which is attached to this permit as Exhibit B and Attachment H and is incorporated by reference.

FORTY-NINE: The permittee should contact the U.S. Army Corps of Engineers, Sacramento District, Regulatory Branch, 1325 J Street, Sacramento, California 95814, telephone (916) 557-5250, as compliance with Section 10 of the Rivers and Harbors Act and/or Section 404 of the Clean Water Act may be required.

FIFTY: This permit shall run with the land and all conditions are binding on permittee's successors and assigns.



SAN JOAQUIN COUNTY
**FLOOD CONTROL & WATER
CONSERVATION DISTRICT**

P. O. BOX 1810

1810 EAST HAZELTON AVENUE
STOCKTON, CALIFORNIA 95201
TELEPHONE (209) 468-3000
FAX NO. (209) 468-2999

THOMAS R. FLINN
DIRECTOR OF PUBLIC WORKS
FLOOD CONTROL ENGINEER

December 27, 2010

Central Valley Flood Protection Board
3310 El Camino Avenue
Sacramento, California 95821

Attention: Floodway Protection Section

SUBJECT: CENTRAL VALLEY FLOOD PROTECTION BOARD PERMIT APPLICATION
OF CALTRANS AT THE STATE HIGHWAY ROUTE 99 CROSSING OF
THE SOUTH FORK OF SOUTH LITTLEJOHNS CREEK

Gentlemen:

Reference is made to the Central Valley Flood Protection Board Permit Application of the California Department of Transportation to widen the highway bridge over the South Fork of South Littlejohns Creek. The existing four-lane bridge will be widened within the median to add two lanes. Twelve piles will be placed to support the proposed median. The project is located at the State Highway Route 99 crossing of the North Fork of South Littlejohns Creek, 2,800 feet north of Lone Tree Creek, in San Joaquin County, in section 29, Township 1 South, Range 7 East, Mount Diablo Base and Meridian.

The San Joaquin County Flood Control and Water Conservation District (District) has reviewed the Central Valley Flood Protection Board Permit application of the City of Stockton and endorses the project subject to the following conditions:

1. The District shall not be responsible for the maintenance of the facilities specified in this Permit.
2. The District shall not be held liable for damage(s) to the permitted encroachment(s) due to the District's operation, maintenance, flood fight, inspection, or emergency repairs.
3. The Permittee or the Successors-In-Interest shall be responsible for the modification or possible removal of the facilities, as requested by the District, if required for any future flood control plans at the Permittee's sole cost and expense.
4. The Permittee shall be liable for any damage to the South Fork of South Littlejohns Creek that may occur as a result of this project.
5. The project shall be constructed in accordance with the plans, dated June 11, 2010, submitted with the application, dated October 6, 2010. Any revisions to the project will require the submittal of the revised plans to the District for review and approval.
6. No work shall be allowed in the South Fork of South Littlejohns Creek channel between November 1st and April 15th without prior approval of the District.
7. The Permittee or Successors-In-Interest shall keep the encroachments properly maintained in accordance with applicable current or future local, State and Federal standards.

8. Bank and channel stabilization material (riprap) shall be placed in a manner such that no reduction in channel cross-section or increase in base flood elevation will result.
9. The piles shall be constructed parallel to the direction of flow, and inline with the existing supports.
10. Stockpiled materials, coffer dams, and construction equipment shall be removed from the floodway prior to November 1.
11. The Permittee shall restore the South Fork of South Littlejohns Creek's invert and banks to the condition that existed prior to commencement of work.
12. Upon completion of the project, the Permittee shall submit a hard copy and an electronic copy in AutoCAD and PDF format of the as-built drawings to:

San Joaquin County Flood Control and Water Conservation District
1810 East Hazelton Avenue
Stockton, California 95205

If there are any questions regarding these comments, please contact me at (209) 953-7617.

Sincerely,



BARRY O'REGAN, P.E.
Acting Engineering Division Manager

BO:SS:mk
FM-10L038-M1



End of Project

South Fork South Littlejohns Creek

\\sac-filsv2\projects\63725-SR99-Manteca-French-Camp-Interchange\map_docs\map\ProjectLocation.mxd

Project Study Area

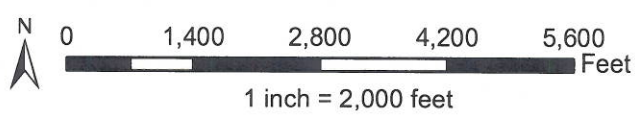

Project Location Map
Figure 2A - S. Fork South Littlejohns Creek



Figure 1
Vicinity Map

STATE OF CALIFORNIA
DEPARTMENT OF TRANSPORTATION
PROJECT PLANS FOR CONSTRUCTION ON
STATE HIGHWAY
IN SAN JOAQUIN COUNTY
IN AND NEAR MANTECA AND STOCKTON ON STATE ROUTE 99
FROM AUSTIN ROAD OVERCROSSING TO 0.40 MI
SOUTH OF ARCH ROAD UNDERCROSSING

TO BE SUPPLEMENTED BY STANDARD PLANS DATED MAY 2006

DIST	COUNTY	ROUTE	POST MILES TOTAL PROJECT	SHEET NO.	TOTAL SHEETS
10	SJ	99	4.9/15.0	1	87



Date plotted: 05/20/2010 9:55 AM
 REGISTRATION No. LICENSE Exp DATE DATE SIGNED
 CALTRANS DESIGN OVERSIGHT APPROVAL
 99_A0E610a0001.dgn
 CONSULTANT DESIGN ENGINEER
 JOHN A. BLEMBLES
 99_A0E610 ENV VICINITY MAP.dwg 5/20/2010 9:55:59 AM

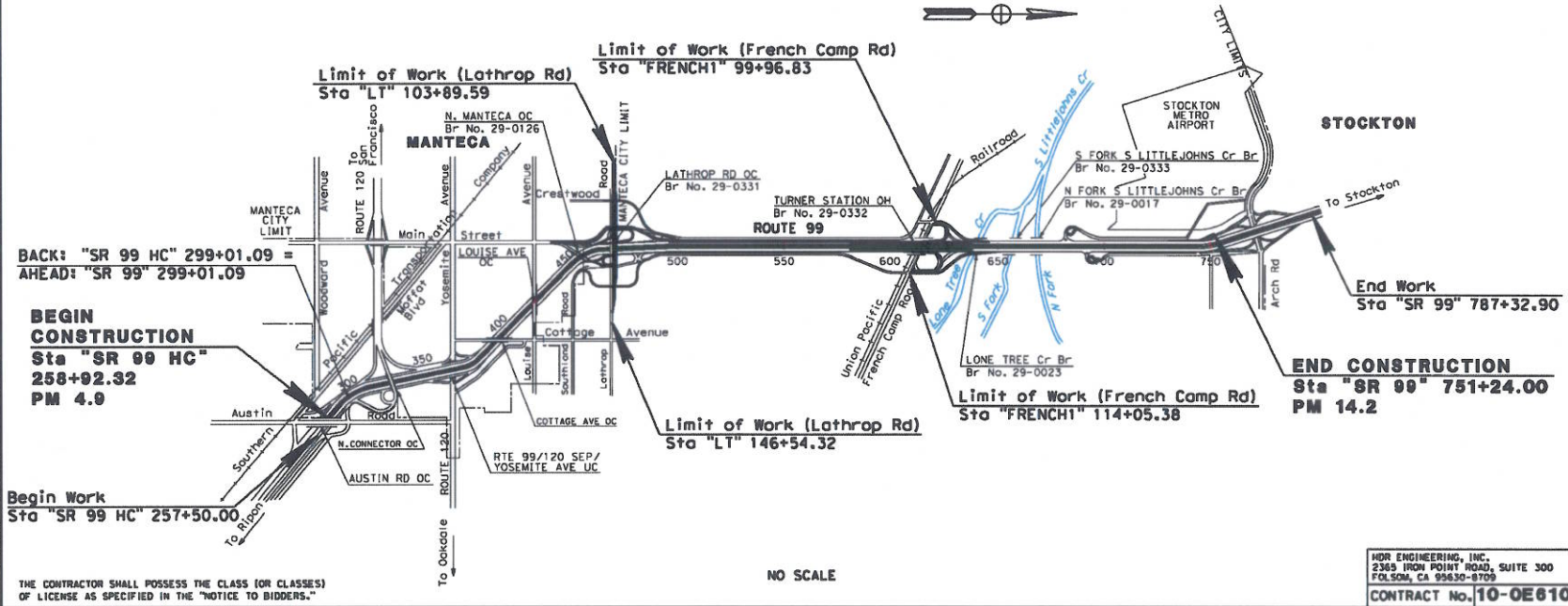

NO SCALE

HDR ENGINEERING, INC.
2385 IRON POINT ROAD, SUITE 300
FOLSOM, CA 95630-8709
CONTRACT No. **10-OE6104**

Figure 2B
Project Location Map

DIST	COUNTY	ROUTE	POST MILES TOTAL PROJECT	SHEET No	TOTAL SHEETS
10	SJ	99	4.9/14.9		

REGISTERED CIVIL ENGINEER DATE 1-20-11

SHARIO PERVAIZ
No. C67068
Exp. 9-30-12
CIVIL
STATE OF CALIFORNIA

PLANS APPROVAL DATE

The State of California or its officers or agents shall not be responsible for the accuracy or completeness of electronic copies of this plan sheet.

SAN JOAQUIN COUNCIL OF GOVERNMENTS
555 E. WEBER AVE.
STOCKTON, CA 95202

HDR ENGINEERING, INC.
2365 IRON POINT ROAD, SUITE 300
FOLSOM, CA 95630

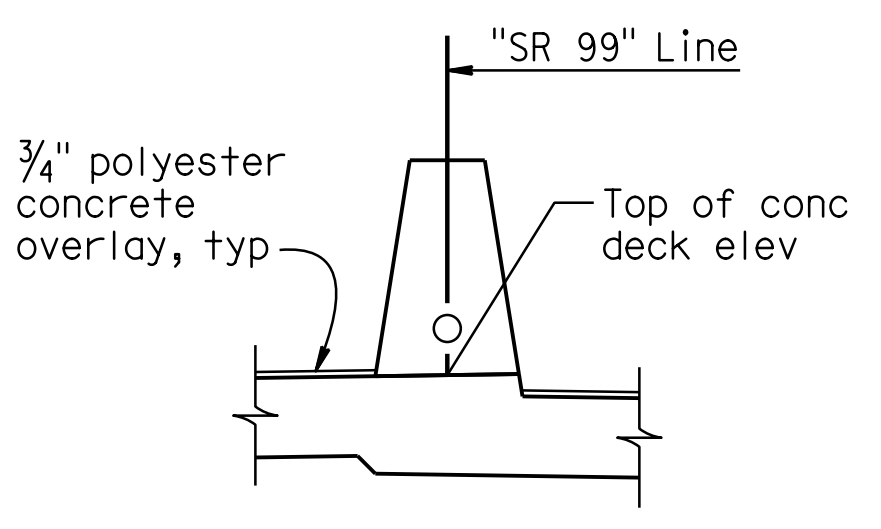
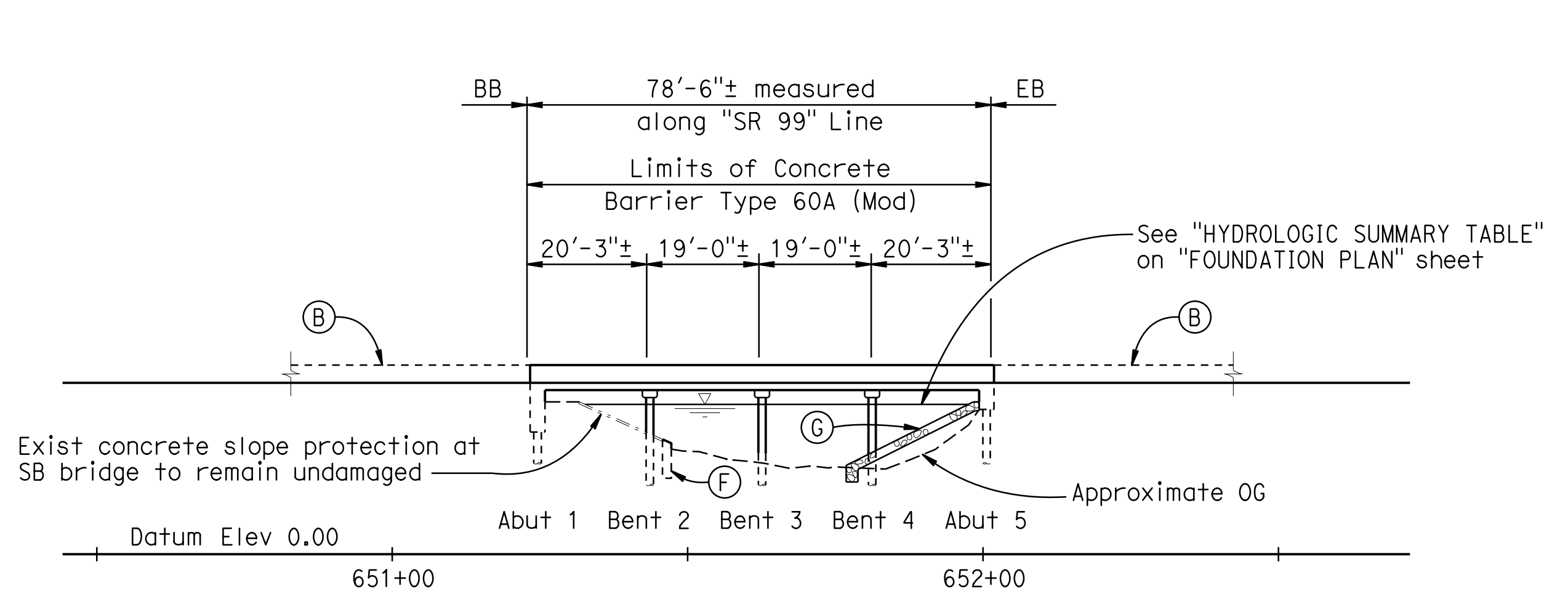

Note:
Concrete Barrier Type 60A (Mod) shall be used on the bridges only and not on the roadway portion.

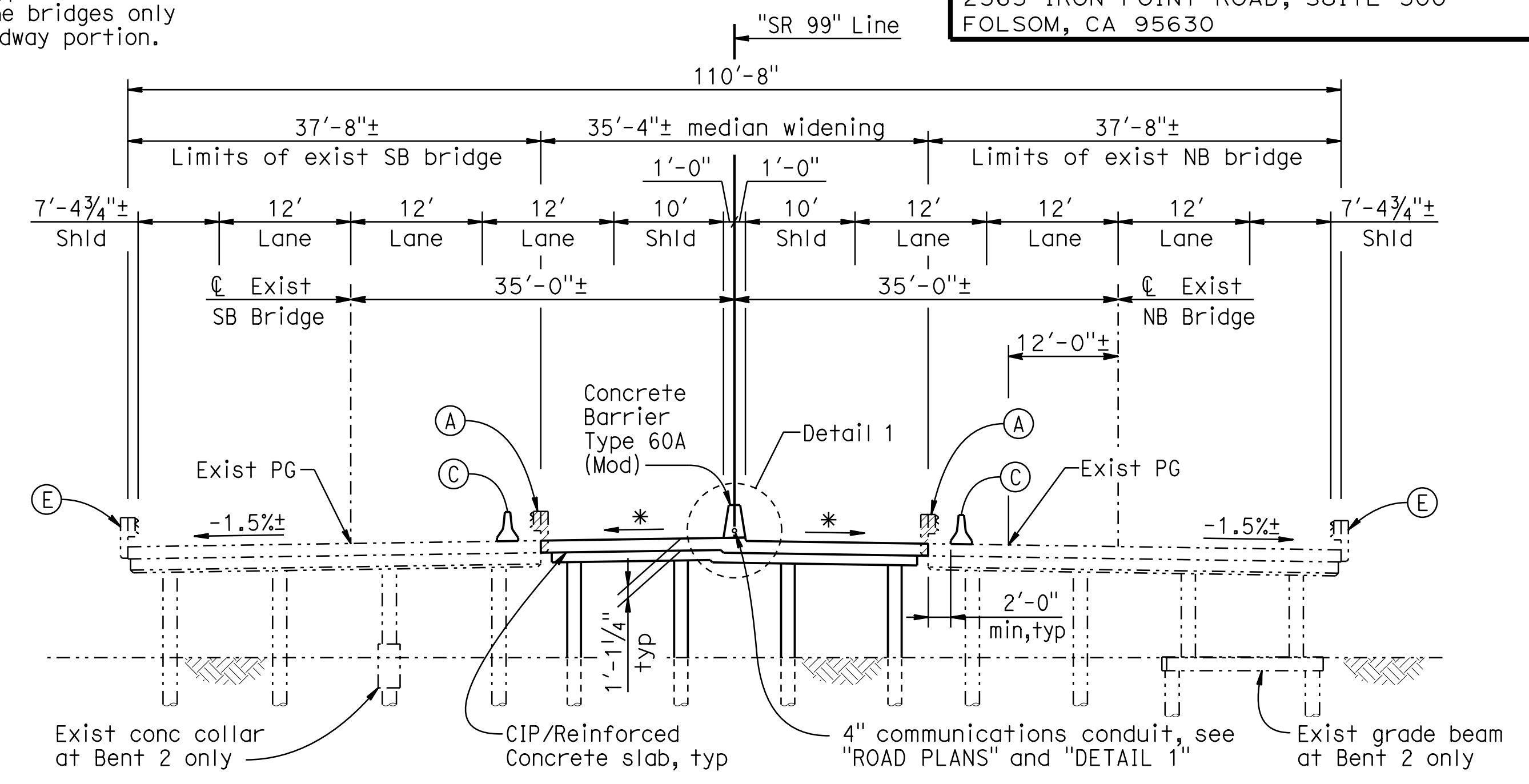

* Match existing PG and cross slope.

TYPICAL SECTION

- Notes:
1. For "GENERAL NOTES", see "DECK CONTOURS" sheet.
2. For "PILE DATA", see "FOUNDATION PLAN" sheet.

- Legend:
- (A) Existing Metal Beam Bridge Railing to be removed and posts to be salvaged.
 - (B) Concrete Barrier Type 60C, see "ROAD PLANS"
 - (C) Temporary Railing (Type K), see "ROAD PLANS".
 - (D) Existing Metal Beam Guard Railing to be removed, see "ROAD PLANS".
 - (E) Existing Metal Guard Bridge Railing to remain.
 - (F) Remove & reconstruct existing cut-off wall at Abutment 1 of existing SB bridge see "ABUTMENT DETAILS" sheet.
 - (G) Rock Slope Protection, see "ROAD PLANS".
 - Indicates new structure.
 - - - Indicates existing structure.
 - [Hatched Box] Indicates Rock Slope Protection, see "ROAD PLANS".
 - [Diagonal Lines Box] Indicates limits of remove asphalt concrete surfacing (2"±), prepare concrete bridge deck surface, place 3/4" min polyester concrete overlay and groove polyester concrete overlay.
 - [Vertical Lines Box] Indicates limits of prepare concrete bridge deck surface, place 3/4" min polyester concrete overlay and groove polyester concrete overlay.

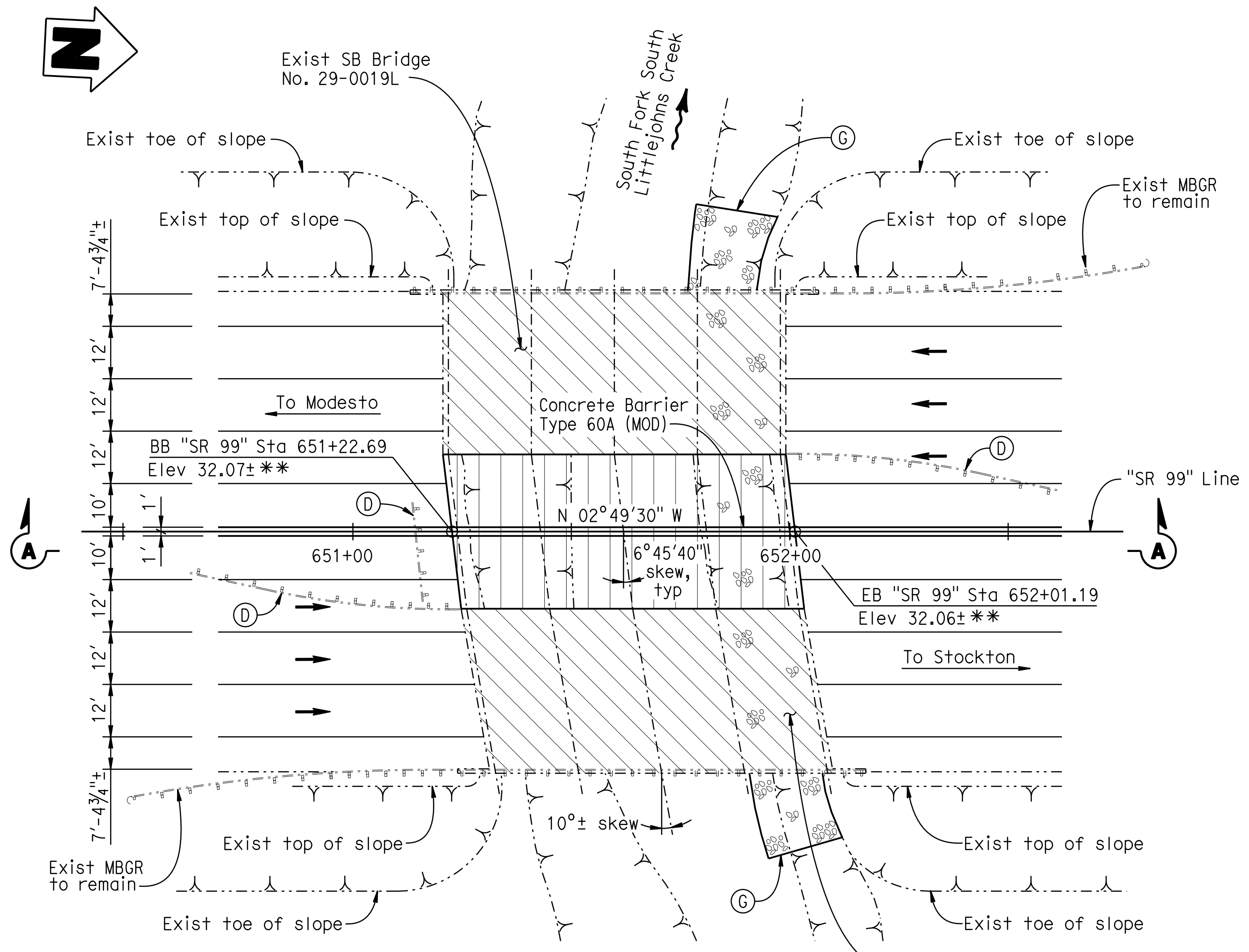

*Elevation is at top of concrete deck as shown in "DETAIL 1".

Note:
The Contractor shall verify all controlling field dimensions before ordering or fabricating any materials.

DESIGN OVERSIGHT	DESIGN BY S PERVAIZ	CHECKED P CHENG	LOAD & RESISTANCE FACTOR DESIGN	LIVE LOADING: HL93 W/"LOW-BOY"; PERMIT DESIGN VEHICLE
SIGN OFF DATE	DETAILS BY J VOUGHT	CHECKED P CHENG	LAYOUT BY S PERVAIZ	CHECKED T KENG
	QUANTITIES BY M KOCHLY	CHECKED J NAUMAN	SPECIFICATIONS BY T KENG	PLANS AND SPECS COMPARED J MANISCALCO

PREPARED FOR THE
STATE OF CALIFORNIA
DEPARTMENT OF TRANSPORTATION

JOHN A. KLEMUNES, JR.
PROJECT ENGINEER

BRIDGE NO. 29-0019
POST MILES 12.33

FRENCH CAMP SLOUGH BRIDGE (WIDEN)
GENERAL PLAN

DIST	COUNTY	ROUTE	POST MILES TOTAL PROJECT	SHEET No	TOTAL SHEETS
10	SJ	99	4.9/14.9		

REGISTERED CIVIL ENGINEER 1-20-11 DATE

SHARIO PERVAIZ
No. C67068
Exp. 9-30-12
CIVIL
STATE OF CALIFORNIA

PLANS APPROVAL DATE

The State of California or its officers or agents shall not be responsible for the accuracy or completeness of electronic copies of this plan sheet.

SAN JOAQUIN COUNCIL OF GOVERNMENTS
555 E. WEBER AVE.
STOCKTON, CA 95202
HDR ENGINEERING, INC.
2365 IRON POINT ROAD, SUITE 300
FOLSOM, CA 95630

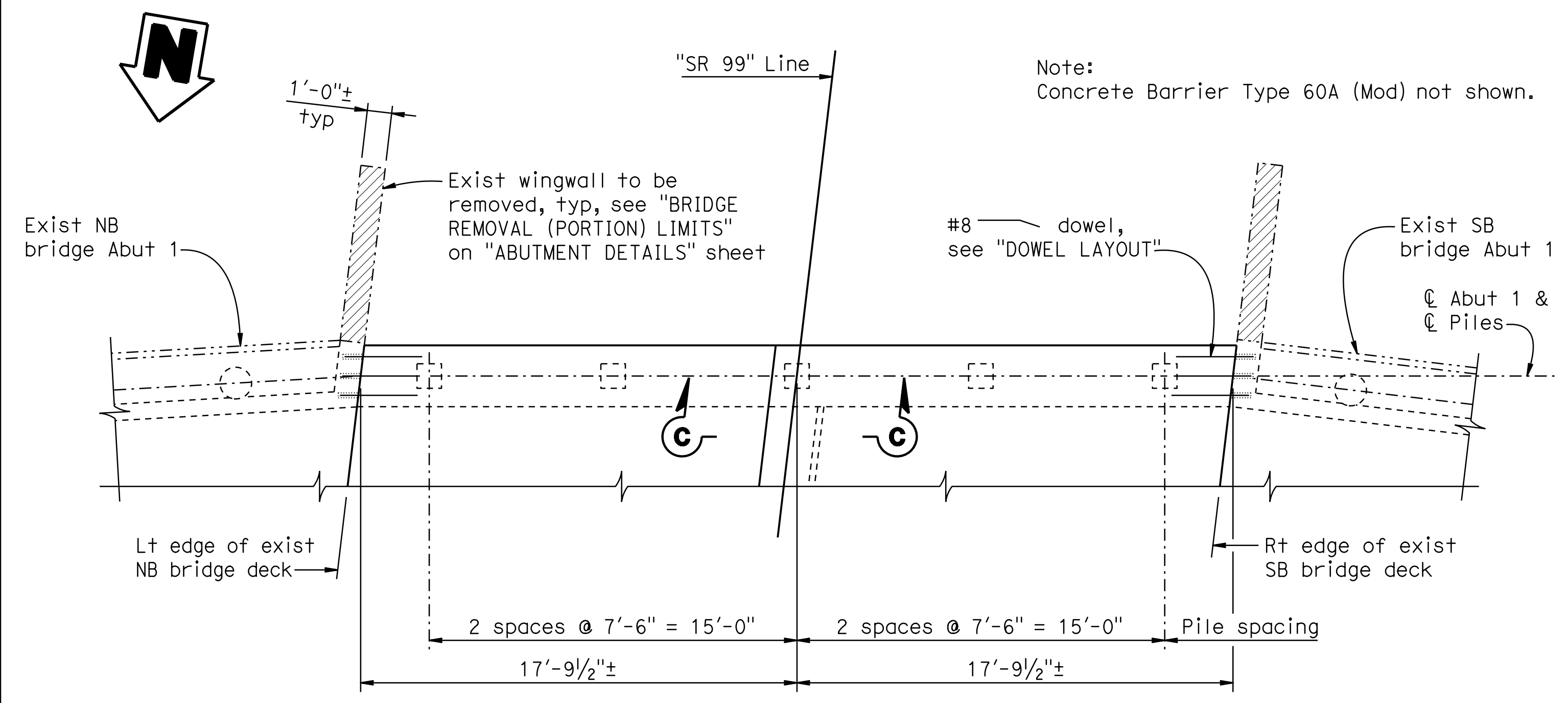

PARTIAL PLAN

1/4" = 1'-0"
Note: Abut 1 shown, Abut 5 similar.

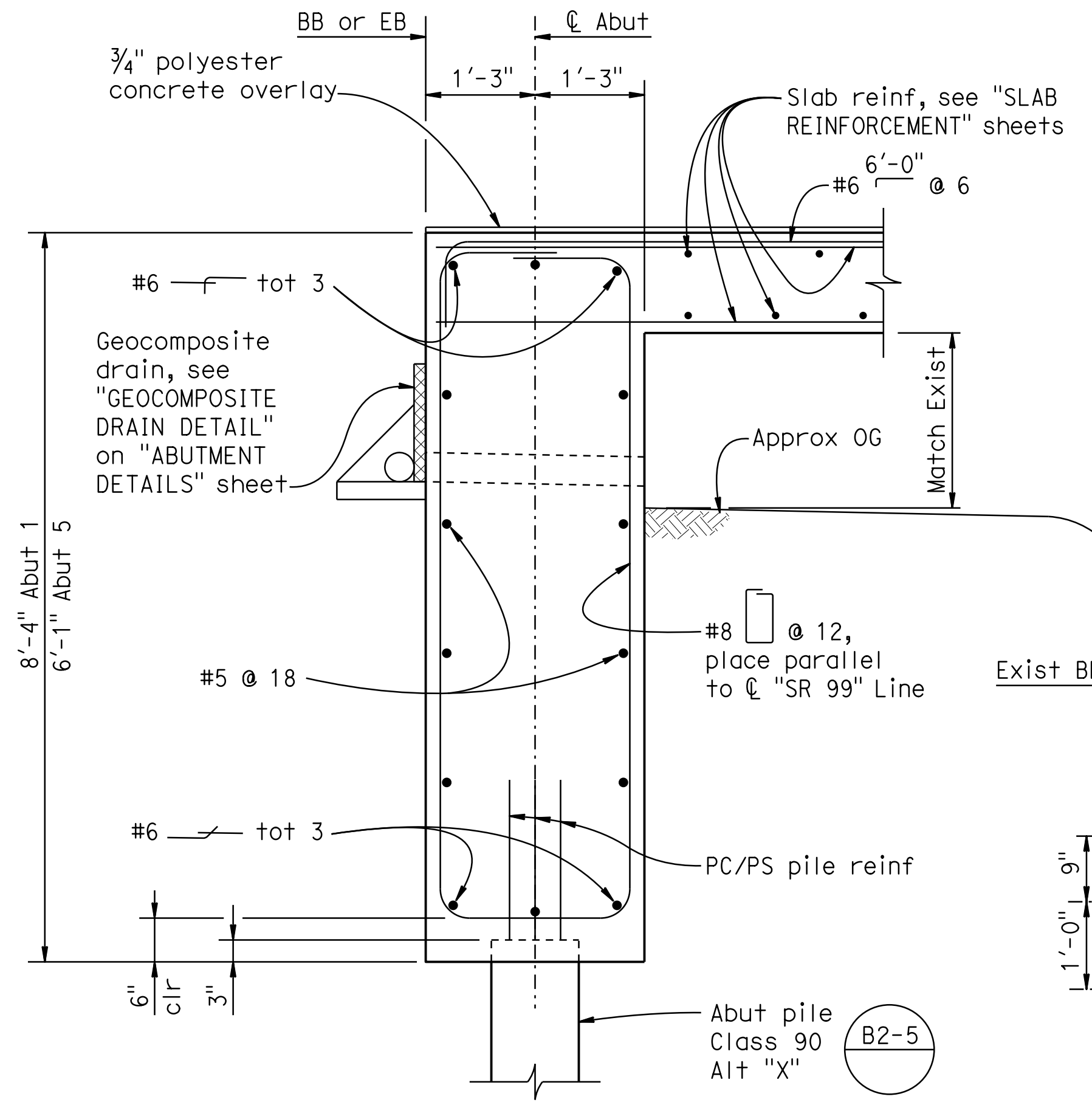

SECTION A-A

3/4" = 1'-0"

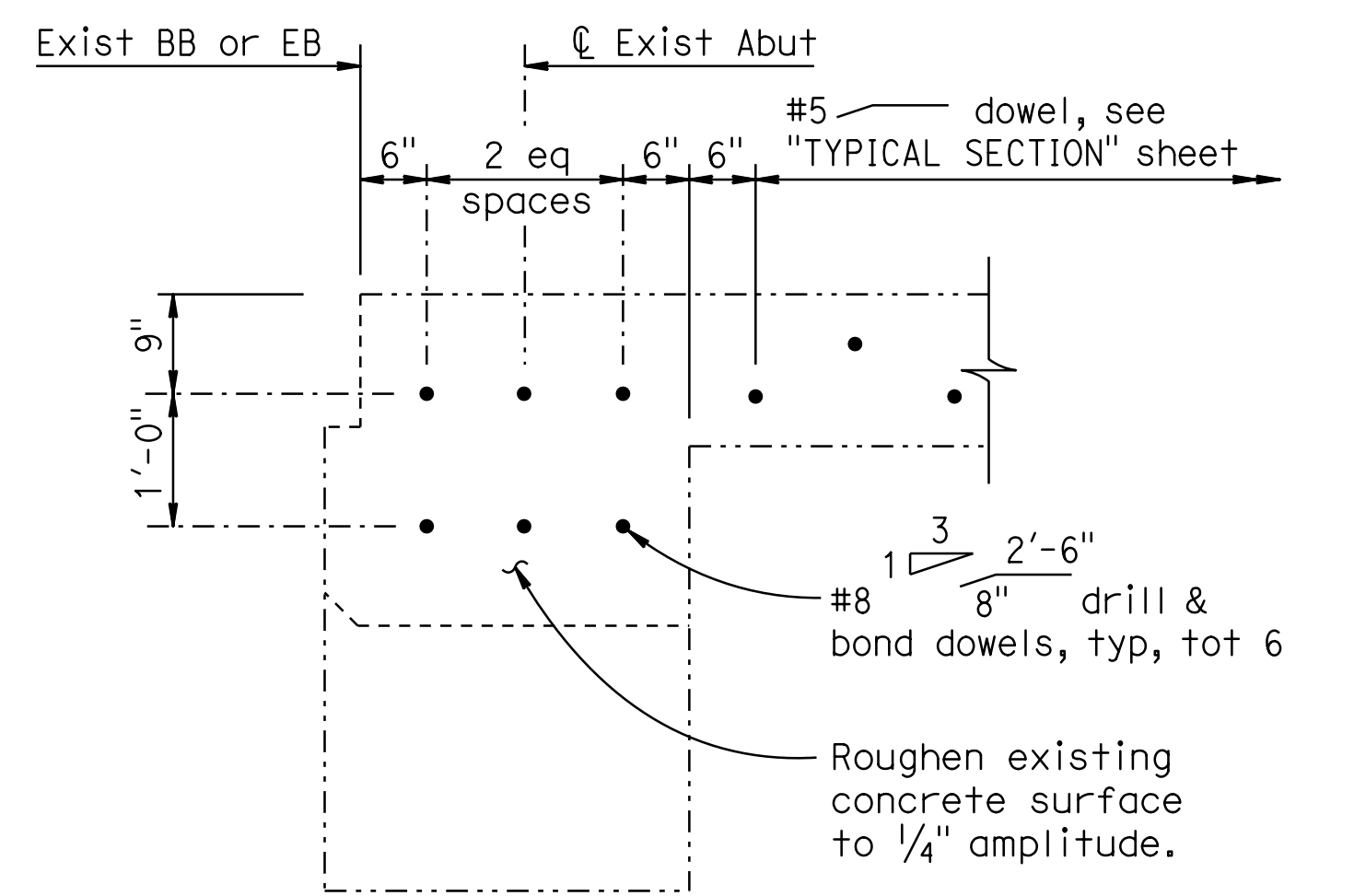

DOWEL LAYOUT

3/4" = 1'-0"

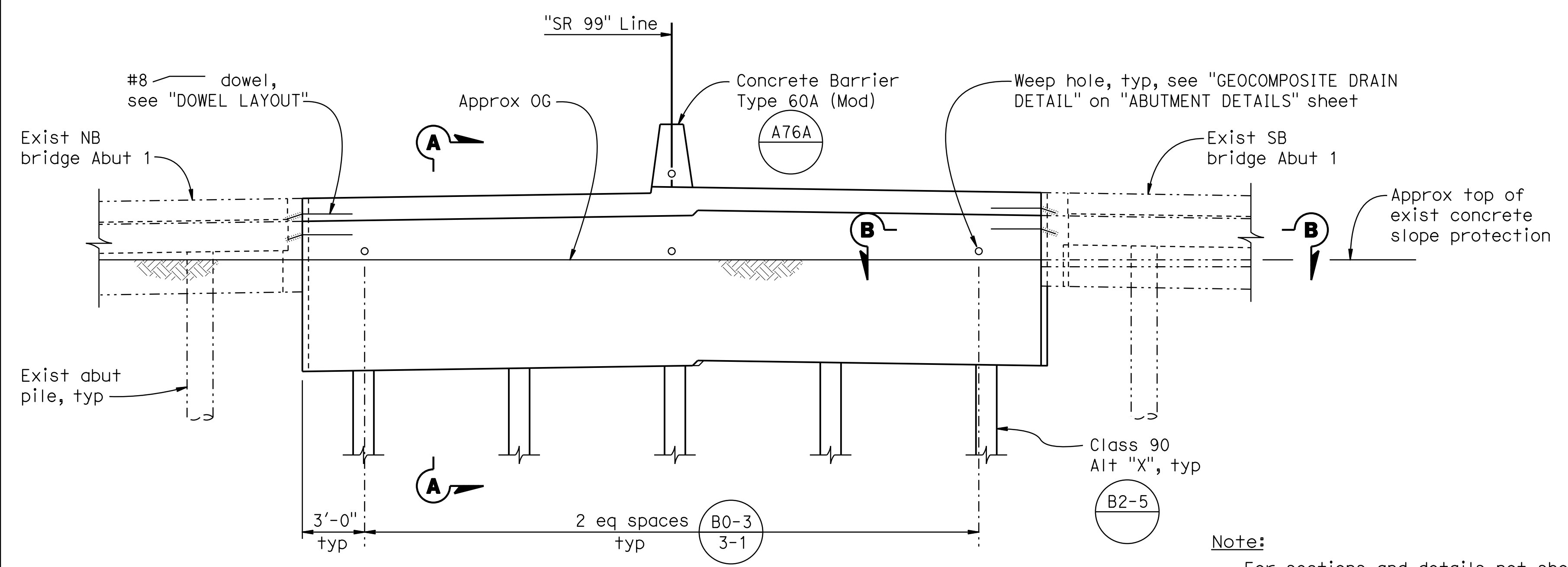

ELEVATION

1/4" = 1'-0"
Note: Abut 1 shown, Abut 5 similar.

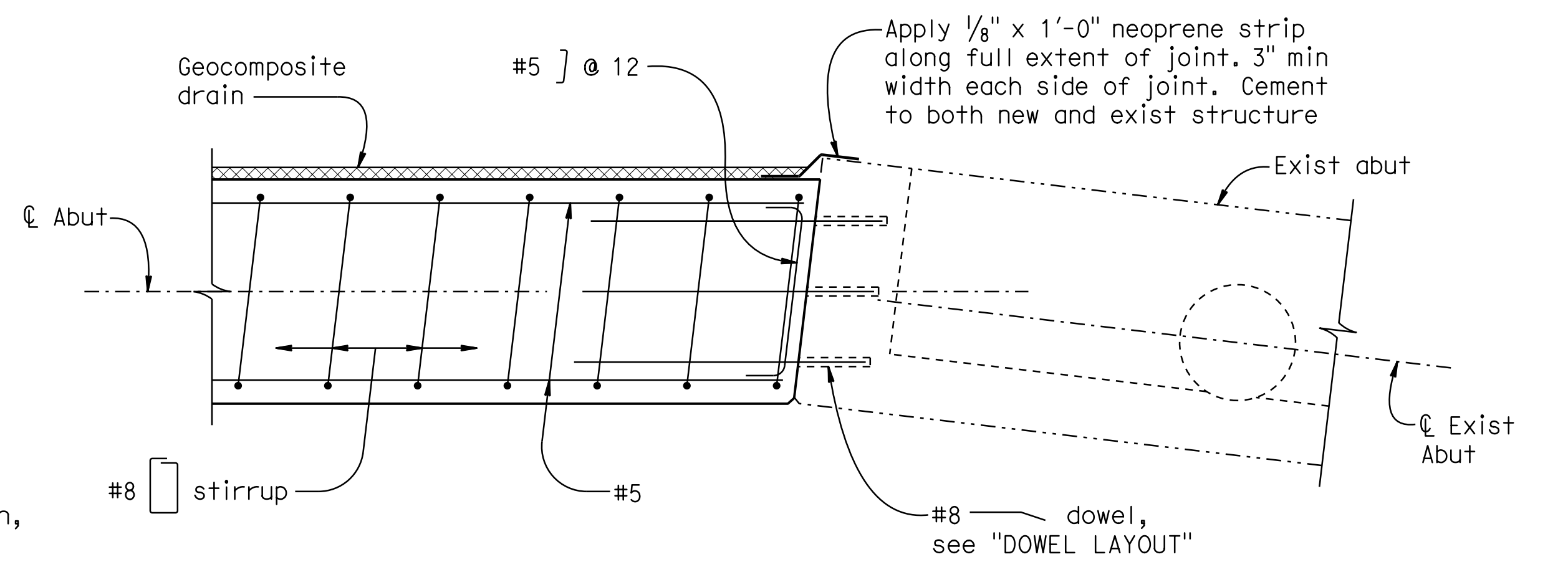

SECTION B-B

3/4" = 1'-0"

Note:
For sections and details not shown, see "ABUTMENT DETAILS" sheet.

- Legend:
- Indicates limits of bridge removal (portion).
 - Indicates existing structure.
 - Indicates new structure.

Note:
The Contractor shall verify all controlling field dimensions before ordering or fabricating any materials.

DESIGN OVERSIGHT	DESIGN BY S PERVAIZ	CHECKED P CHENG	PREPARED FOR THE STATE OF CALIFORNIA DEPARTMENT OF TRANSPORTATION	BRIDGE NO. 29-0019	FRENCH CAMP SLOUGH BRIDGE (WIDEN)	
SIGN OFF DATE	DETAILS BY J VOUGHT	CHECKED P CHENG		PROJECT ENGINEER JOHN A. KLEMUNES, JR.		POST MILE 12.33
DESIGN DETAIL SHEET (ENGLISH) (REV.7/16/10)	QUANTITIES BY M KOCHLY	CHECKED J NAUMAN		PROJECT NUMBER & PHASE: 1455 10000204401		CONTRACT NO.: 10-0E6111

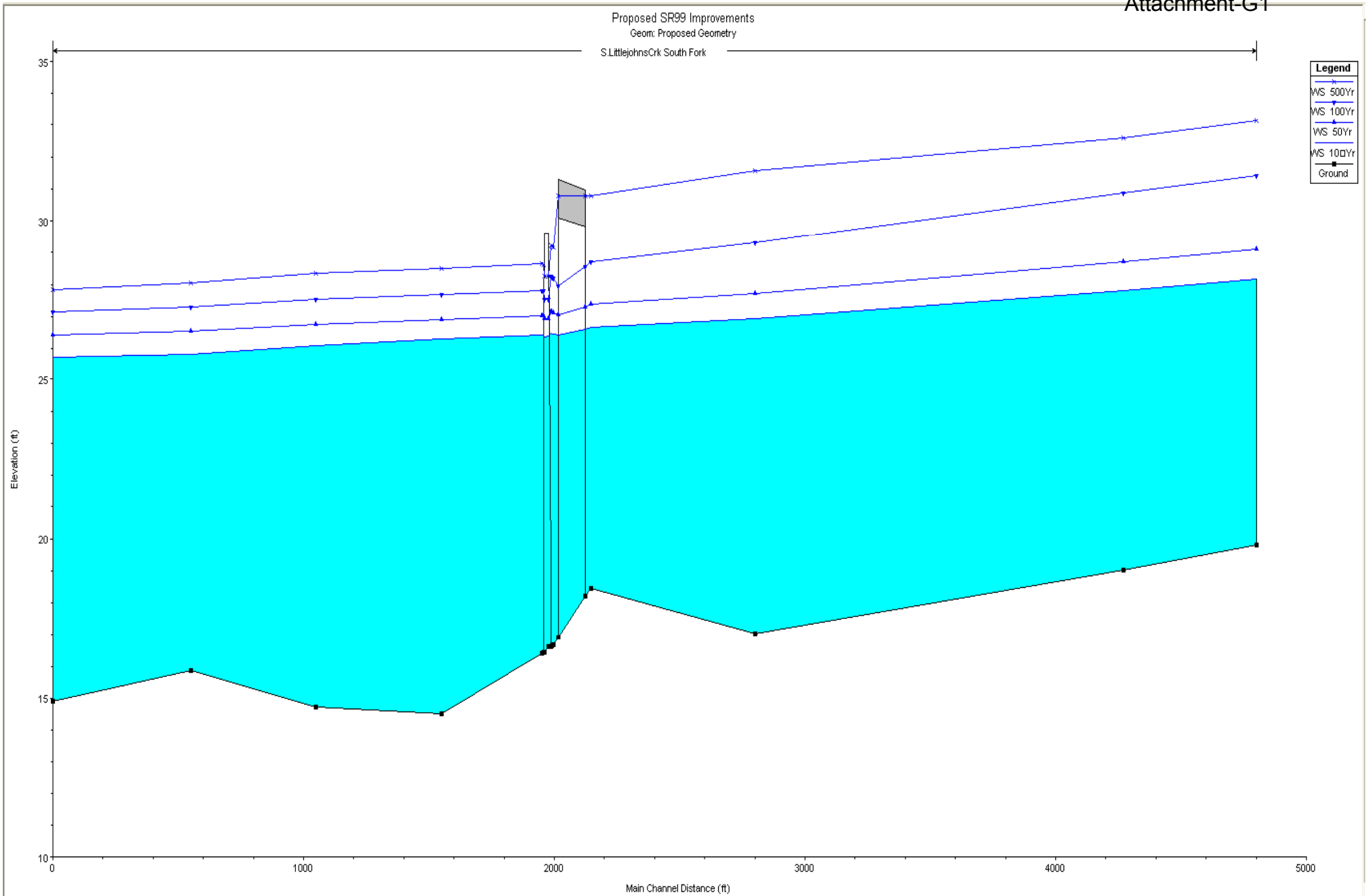

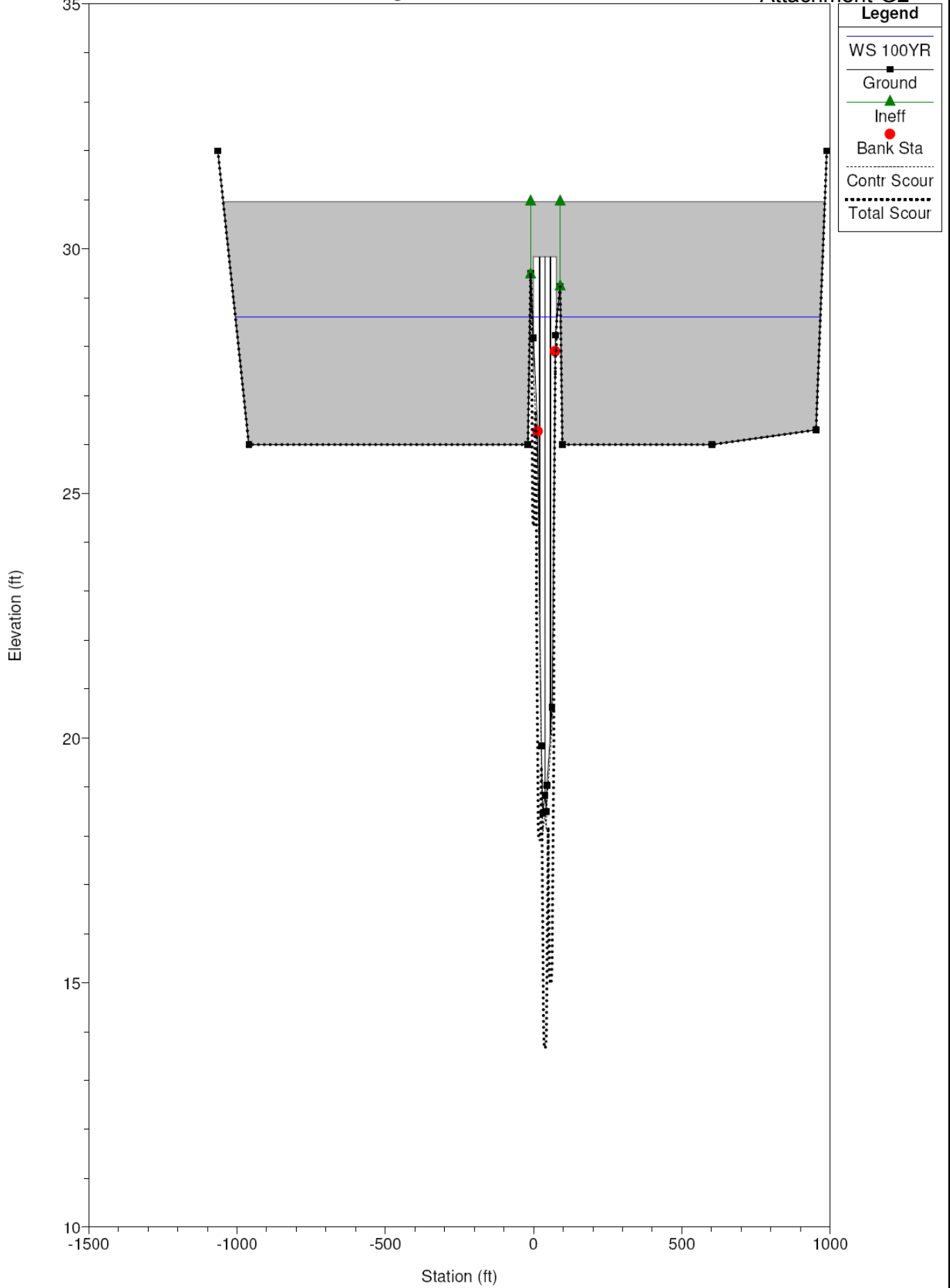



SAN JOAQUIN COUNTY
**FLOOD CONTROL & WATER
CONSERVATION DISTRICT**

P. O. BOX 1810
1810 EAST HAZELTON AVENUE
STOCKTON, CALIFORNIA 95201
TELEPHONE (209) 468-3000
FAX NO. (209) 468-2999

THOMAS M. GAU
DIRECTOR OF PUBLIC WORKS
FLOOD CONTROL ENGINEER

August 31, 2011

David R. Williams, R.C.E.
Central Valley Flood Protection Board
Chief Levee Improvement Section
3310 El Camino Avenue, Room 151
Sacramento, California 95821

SUBJECT: SAN JOAQUIN COUNTY FLOOD CONTROL AND WATER CONSERVATION DISTRICT (DISTRICT) ENDORSEMENT FOR ENCROACHMENT APPLICATIONS NO. 18663 AND NO. 18664 FOR THE STATE HIGHWAY ROUTE 99 MANTECA WIDENING PROJECT AT THE SOUTH FORK OF SOUTH LITTLEJOHNS CREEK, AND AT THE NORTH FORK OF SOUTH LITTLEJOHNS CREEK

Dear Mr. Williams:

The District has reviewed the Central Valley Flood Protection Board Encroachment Permit Applications for the State Highway Route 99 Manteca Widening Project at the North Fork of South Littlejohns Creek (Permit No.18663), and the South Fork of South Littlejohns Creek (Permit No. 18664), and is not concerned that the project will encounter any debris problems at either of these crossing locations during a high-flow event. The District endorses these project applications.

If there are any questions or concerns regarding these endorsement statements, please contact us at (209) 953-7617.

Sincerely,

JOHN I. MAGUIRE
Engineering Services Manager

JIM:SS:to
FM-11H075-T1



Figure 7. View of bridge looking southwest.